



# ABOUT US

The original idea  
makes design distinctive,  
the function makes it work  
and quality adds value

Serge Zuev

## **PRODUCERS OF GYPSUM AIR DIFFUSERS**

We manufacture innovative, modern and elegant air diffusers ideal for ceiling or wall applications. Using our unique gypsum composite, we have created a new generation of beautifully seamless air diffusers designed to complement any room or space. Our patented design is the first truly seamless air diffuser in the UK.

- Innovative – first on the market to be made from a dedicated gypsum composite.
- Modern – manufactured using environmentally friendly processes, with limitless installation possibilities.
- Elegant – our gypsum diffusers maintain the integrity of the interior design and completely blend in with plasterboard walls or ceilings.

## **OUR VISION**

At Ventmann, we know how much time and care it takes to create the perfect interior design and décor. That's why we believe ventilation diffusers should be as aesthetically pleasing and durable as possible. This means no unsightly frames, colour clashing, or cracking. Thanks to our innovative gypsum composite, our diffusers bond seamlessly with the surrounding wall or ceiling, creating a refined look that will compliment any style, from classical opulence to the most streamlined minimalist design. With Ventmann, there is no need to compromise comfort for style.





# LINE





Ventmann LINE diffusers are an elegant and flexible air distribution solution. With LINE, you can create striking interior elements or make the diffusers almost invisible with the slimmer slot models.

LINE diffusers can also be used to create continuous linear designs, making it easy to achieve unique interior design solutions. But they are more than that. But they are more than that. Ventmann diffusers are the first diffusers on the market that can be painted with the same paint as the rest of the surface, leaving no visible frames and without changing the ceiling height.

## SELECTION

For ultimate design flexibility, Ventmann LINE diffusers are available in:

- 1-slot, 2-slot or 3-slot models
- 625mm; 1000mm; 1250mm slot length
- 12mm or 18mm slot width

## INSTALLATION

LINE diffusers are designed to be installed in plasterboard walls or ceilings. Once in place, the edges between the diffuser and the wall or ceiling are filled in, leaving a smooth continuous surface to be painted or finished as required.

Detailed installation instructions are provided with every order.

## ORDERING DETAILS

To order Ventmann LINE diffusers, please visit our website.

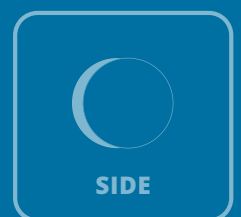
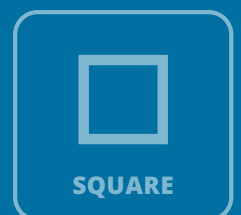
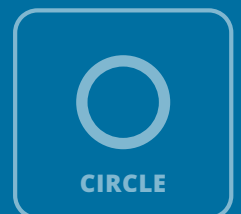

Ventmann — your choice of air elegance.

# LINE 1/12

## SLOT DIFFUSER



**1**  
AMOUNT OF SLOTS

**12 mm**  
WIDTH OF SLOT

**2.5 kg**  
1 M. LENGTH DIFFUSER WEIGHT  
WITHOUT PACKAGING (NET)

**625 / 1000 / 1250**  
STANDARD SLOT LENGTH (MM)

Steel punched sheet. Distributes the air supply through the diffuser.

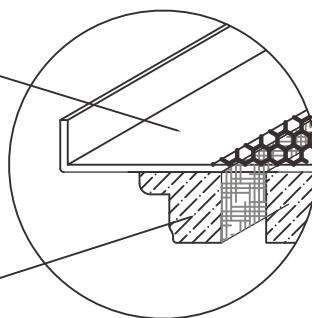

Gypsum mix segment. Sanded, puttied, painted. Suitable for all operations in combination with surface finishing

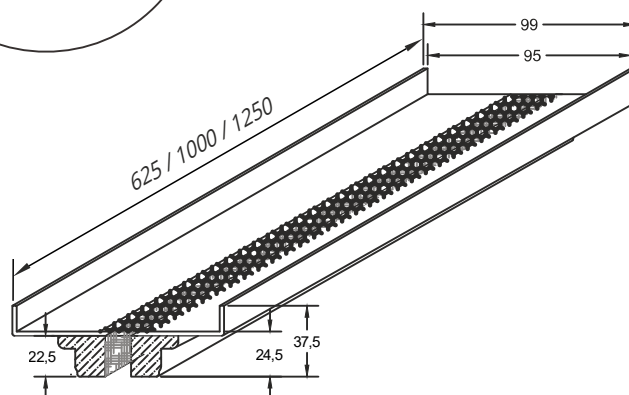
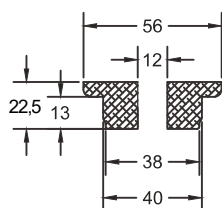

## Airborne noise and resistance, 1 m.

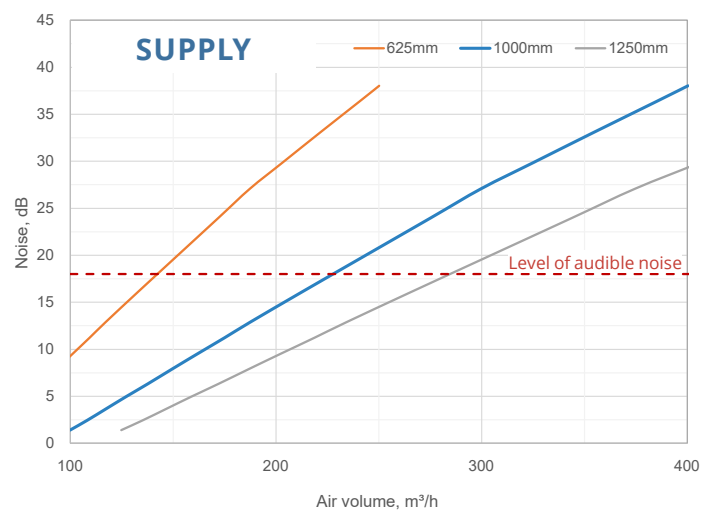
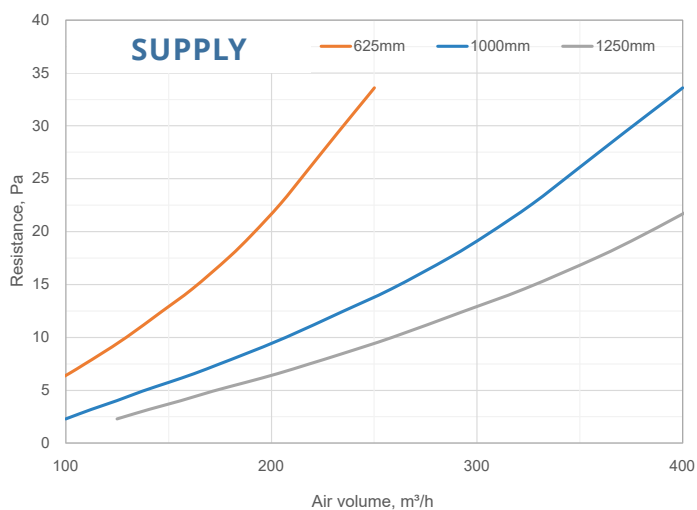

Slim version with a 33% narrower slot, making it less noticeable indoors whilst preserving its technical capabilities. Great choice for subtle integration of the diffuser into minimalist interior designs.

## PERCEPTIBLE AIRSPEED $L_{0,2}(m)$ DISTANCE

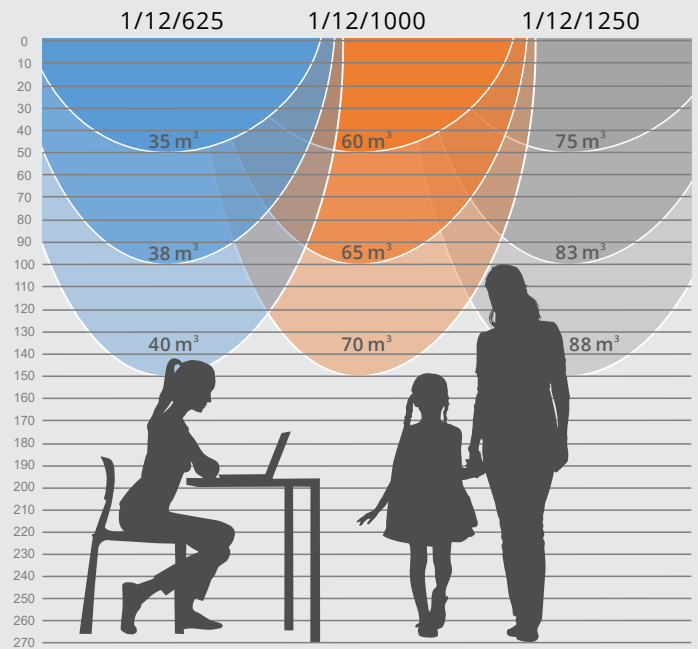

Airflow with Ventmann LINE diffuser at a height of 2.70 m

## PERCEPTIBLE AIRSPEED REACH LIMIT

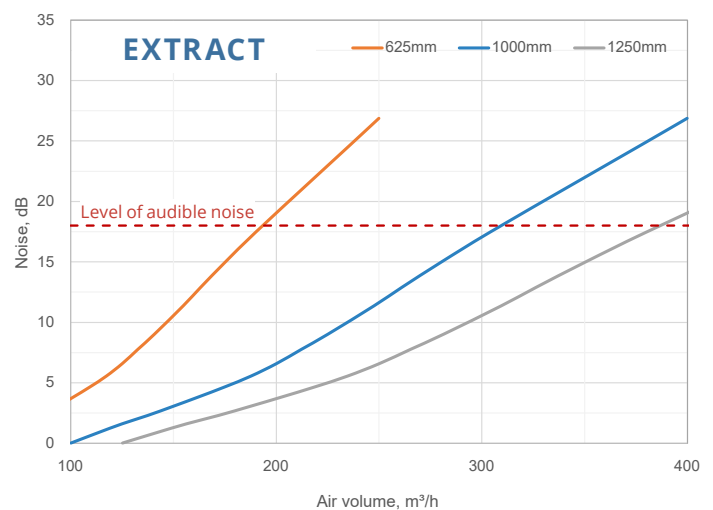
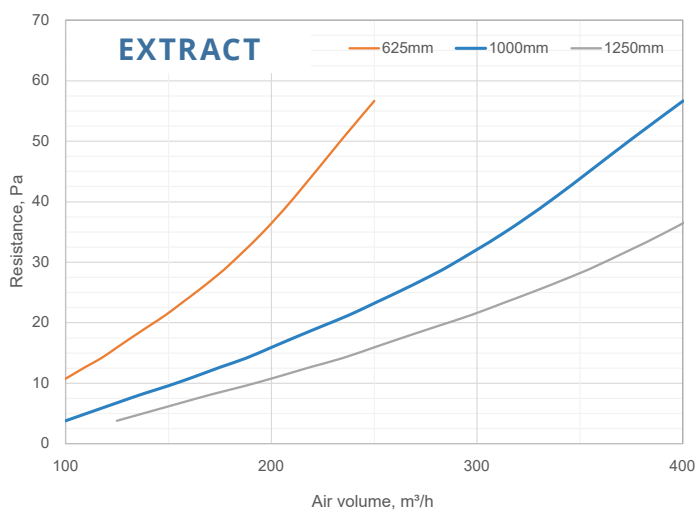
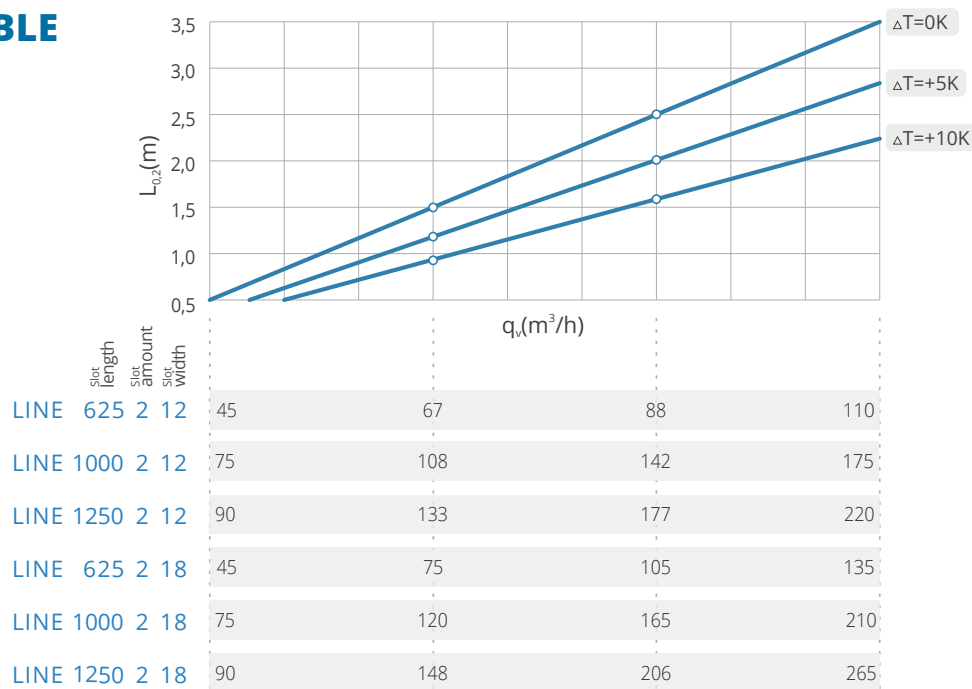



# LINE 1/18

## SLOT DIFFUSER

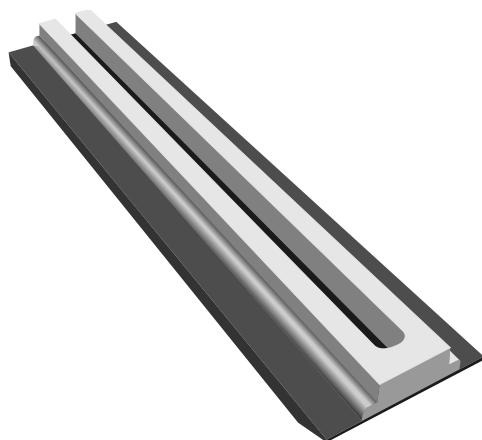

**1**  
AMOUNT OF SLOTS

**18 mm**  
WIDTH OF SLOT

**2.5 kg**  
1 M. LENGTH DIFFUSER WEIGHT  
WITHOUT PACKAGING (NET)

**625 / 1000 / 1250**  
STANDARD SLOT LENGTH (MM)

Steel punched sheet. Distributes the air supply through the diffuser.

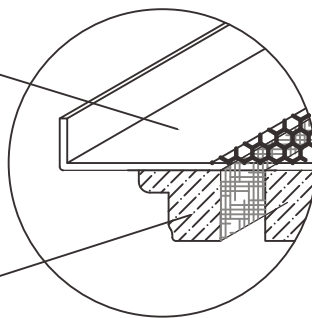

Gypsum mix segment. Sanded, puttied, painted. Suitable for all operations in combination with surface finishing

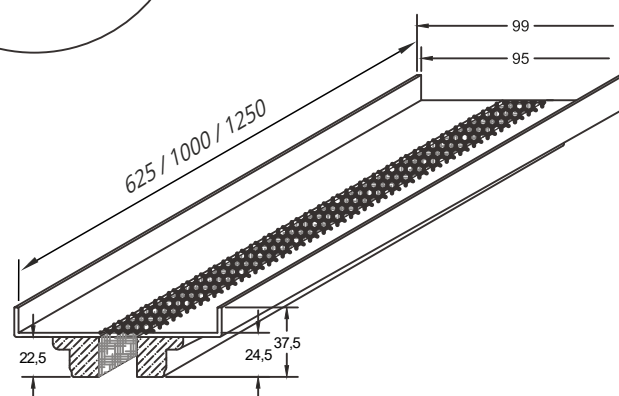
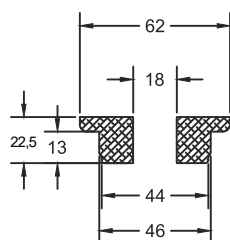

## Airborne noise and resistance, 1 m.

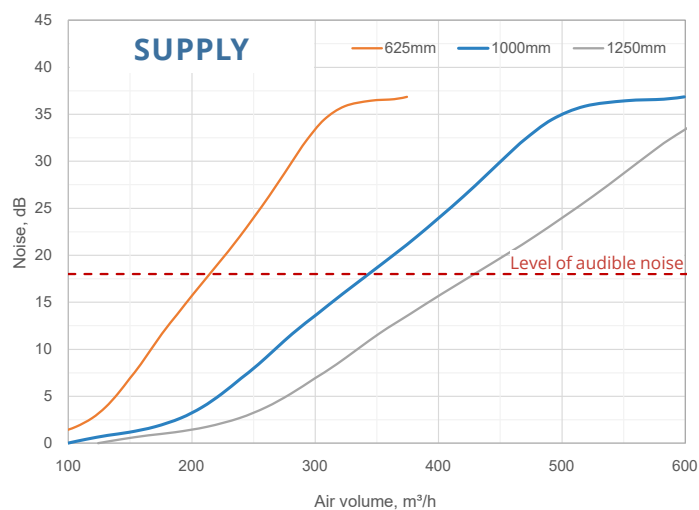
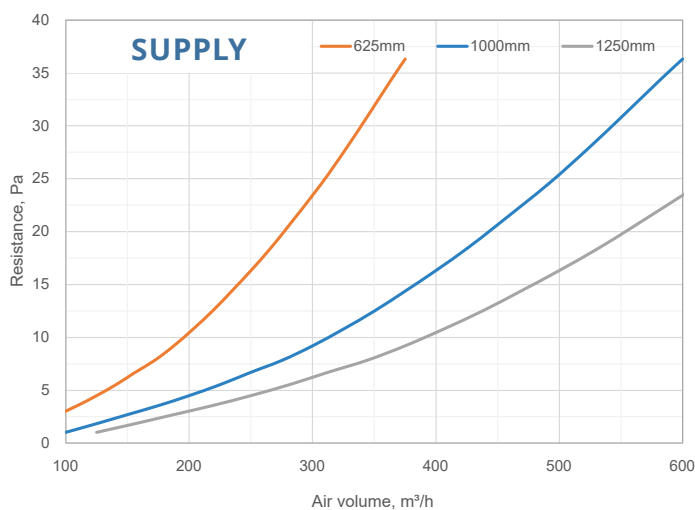



One slot diffuser designed to seamlessly incorporate the ventilation system into the room, adding elegance and exclusivity to any interior design.

## PERCEPTIBLE AIRSPEED $L_{0,2}(m)$ DISTANCE

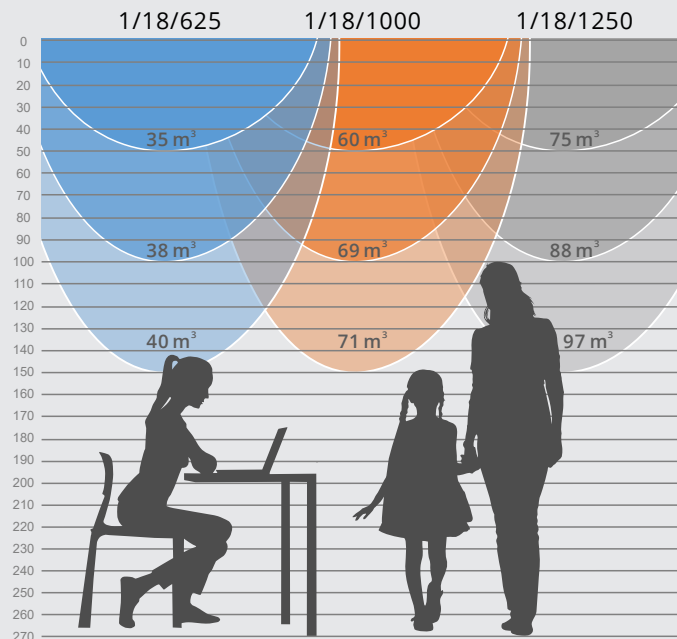

Airflow with Ventmann LINE diffuser at a height of 2.70 m

## PERCEPTIBLE AIRSPEED REACH LIMIT

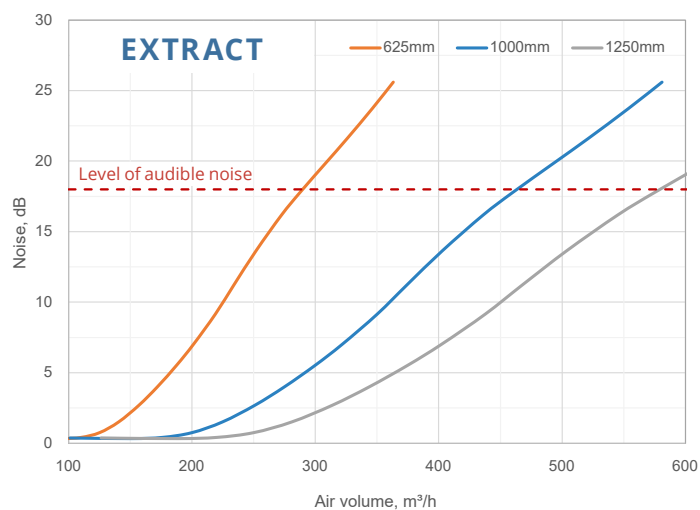
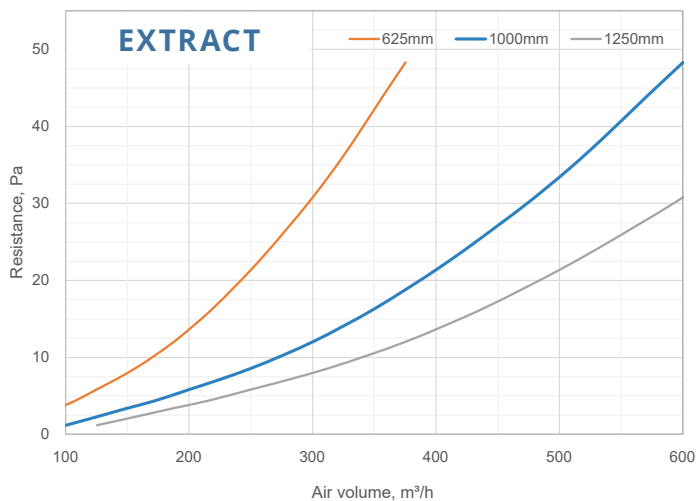
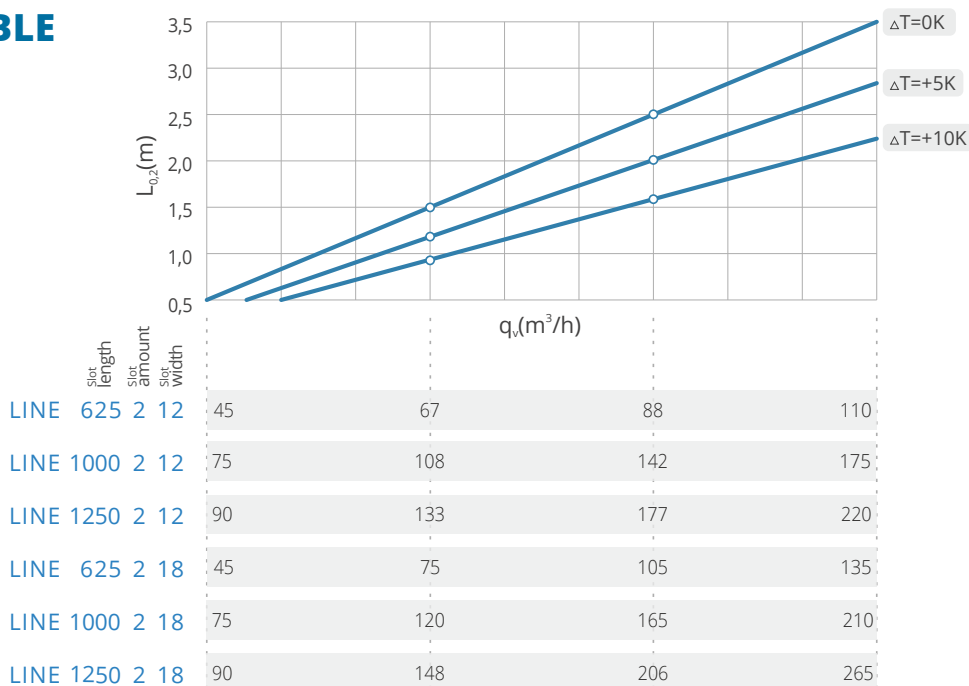

# LINE 2/12

## SLOT DIFFUSER

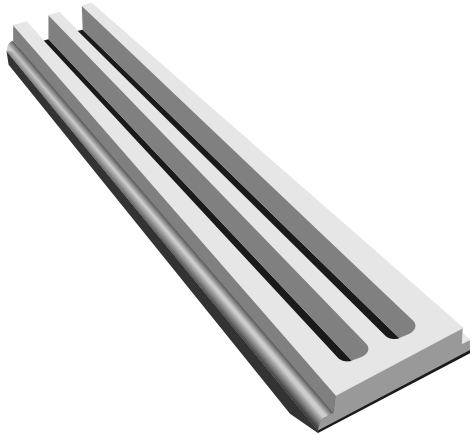

**2**  
AMOUNT OF SLOTS

**12 mm**  
WIDTH OF SLOT

**2.735 kg**  
1 M. LENGTH DIFFUSER WEIGHT  
WITHOUT PACKAGING (NET)

**625 / 1000 / 1250**  
STANDARD SLOT LENGTH (MM)

Steel punched sheet. Distributes the air supply through the diffuser.

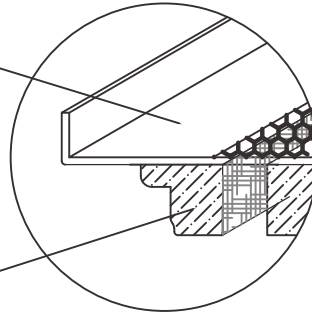

Gypsum mix segment. Sanded, puttied, painted. Suitable for all operations in combination with surface finishing

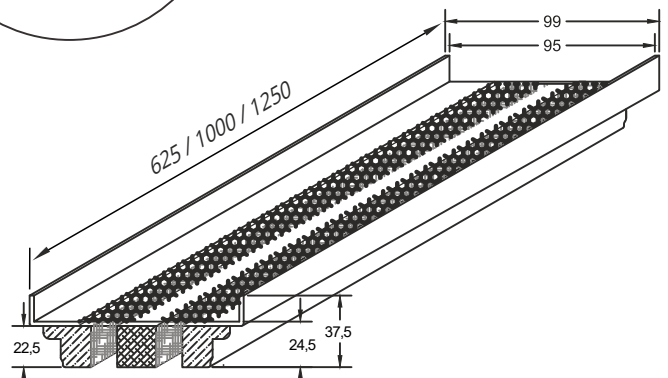
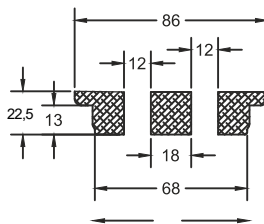

### Airborne noise and resistance, 1 m.

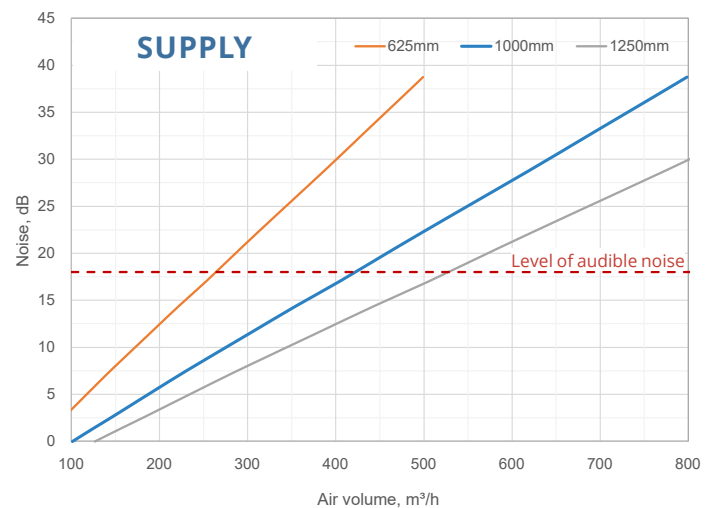
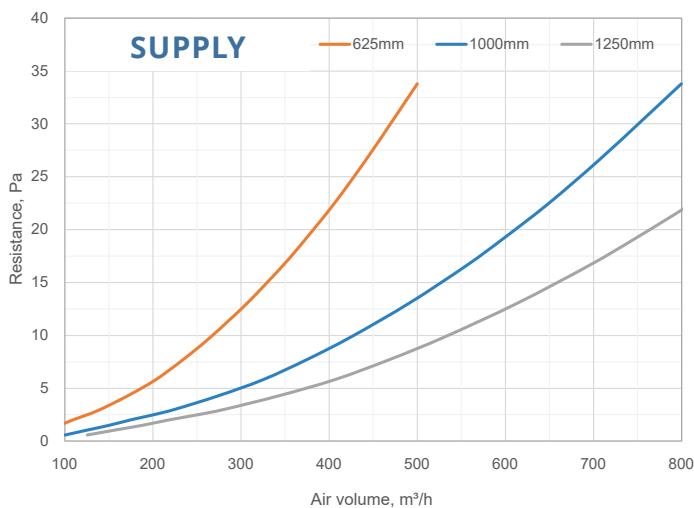

Slim version with two slots which are 33% narrower than the standard model, making it blend in whilst preserving its technical capabilities. An ideal diffuser option for minimalist interior designs.

## PERCEPTIBLE AIRSPEED $L_{0,2}(m)$ DISTANCE

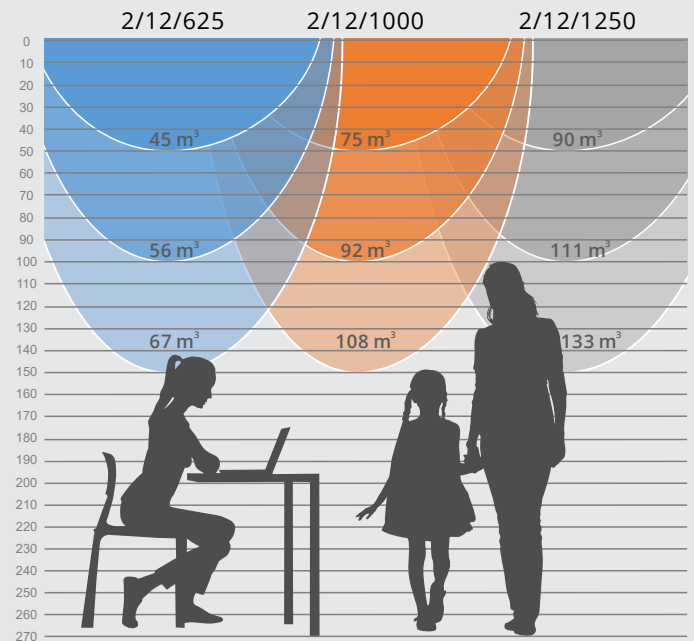

Airflow with Ventmann LINE diffuser at a height of 2.70 m

## PERCEPTIBLE AIRSPEED REACH LIMIT

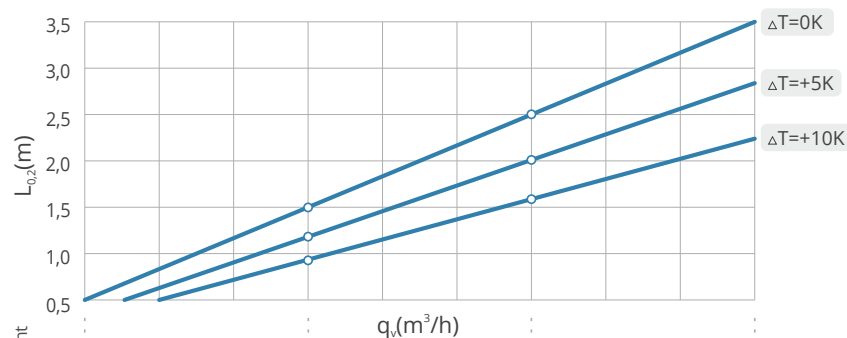

	slot length amount	slot width				
LINE 625 2 12	45	67	88	110		
LINE 1000 2 12	75	108	142	175		
LINE 1250 2 12	90	133	177	220		
LINE 625 2 18	45	75	105	135		
LINE 1000 2 18	75	120	165	210		
LINE 1250 2 18	90	148	206	265		

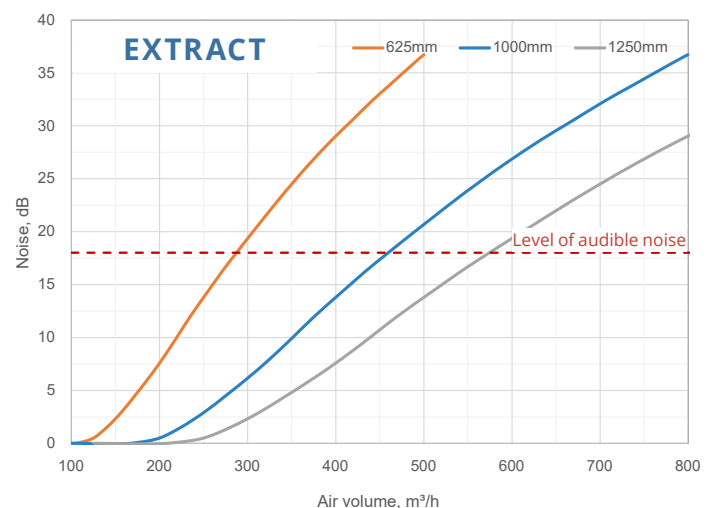
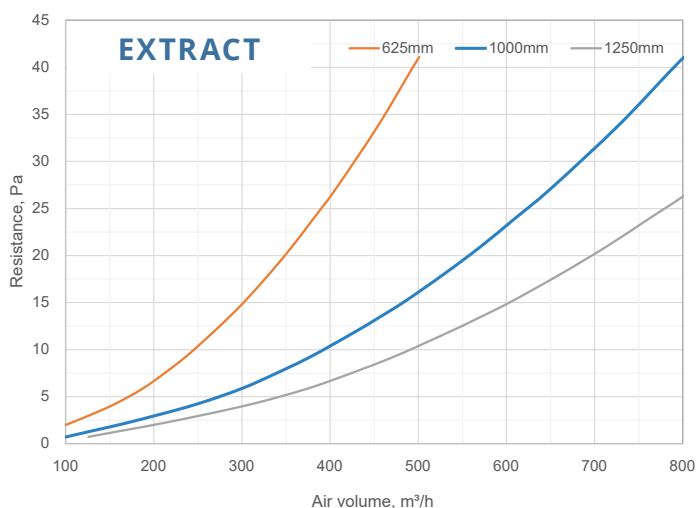

# LINE 2/18

## SLOT DIFFUSER

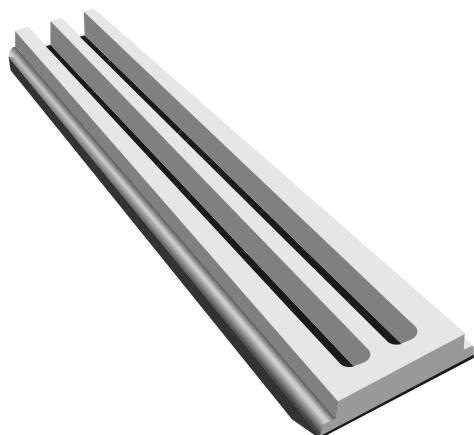

**2**  
AMOUNT OF SLOTS

**18 mm**  
WIDTH OF SLOT

**2.735 kg**  
1 M. LENGTH DIFFUSER WEIGHT  
WITHOUT PACKAGING (NET)

**625 / 1000 / 1250**  
STANDARD SLOT LENGTH (MM)

Steel punched sheet. Distributes the air supply through the diffuser.

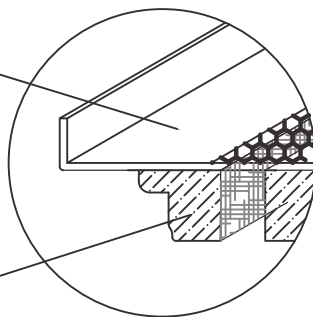

Gypsum mix segment. Sanded, puttied, painted. Suitable for all operations in combination with surface finishing

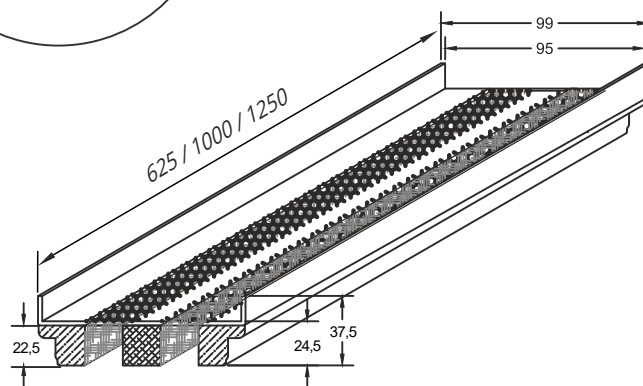
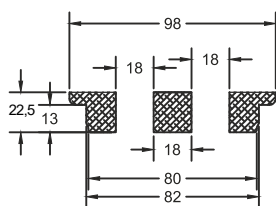

## Airborne noise and resistance, 1 m.

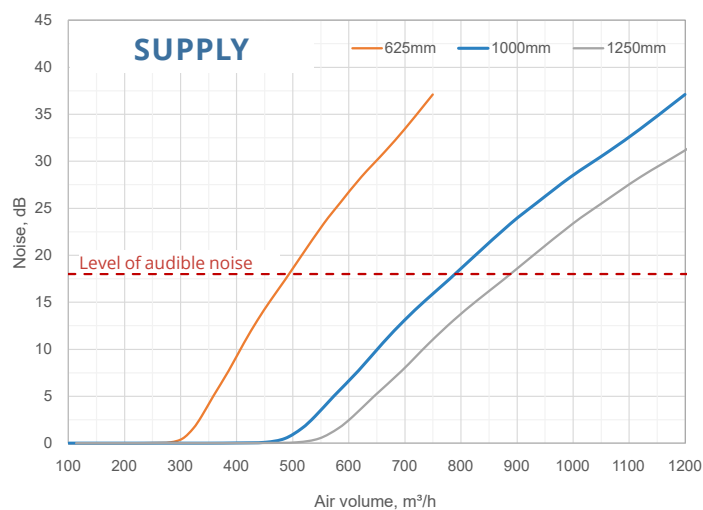
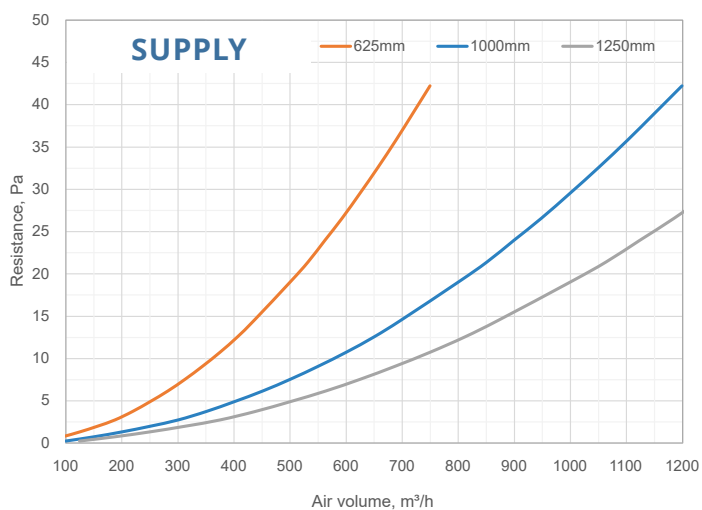



Two-slot diffuser with slightly wider openings to distribute larger air volumes. It can be installed on walls or ceilings and is suitable for supplying or exhausting indoor air.

## PERCEPTIBLE AIRSPEED $L_{0,2}(m)$ DISTANCE

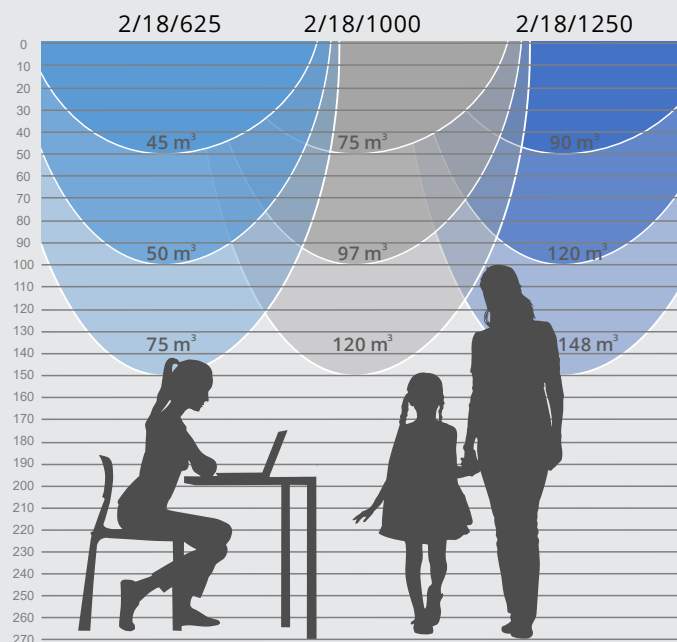

Airflow with Ventmann LINE diffuser at a height of 2.70 m

## PERCEPTIBLE AIRSPEED REACH LIMIT

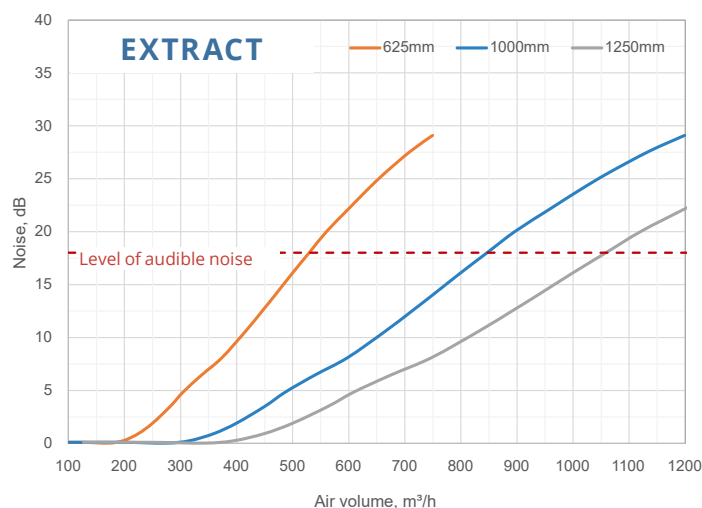
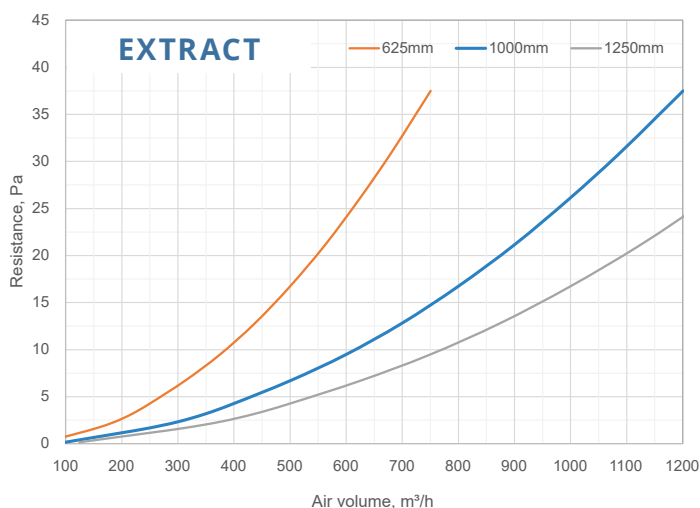
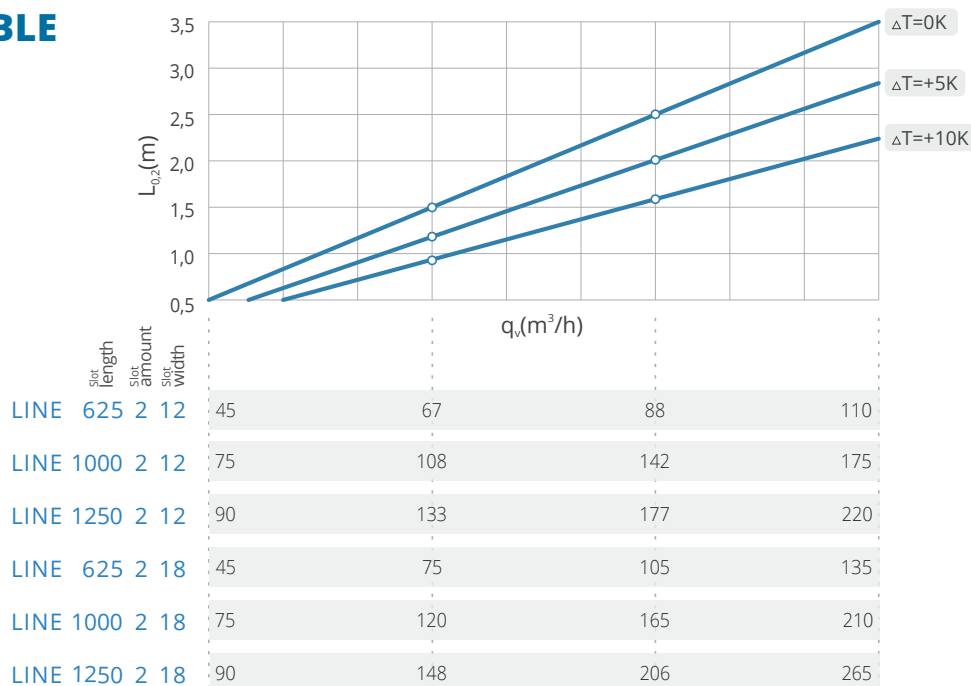

# STANDARD ACOUSTIC BOXES

GTG 75 625

Hole diameter Box length

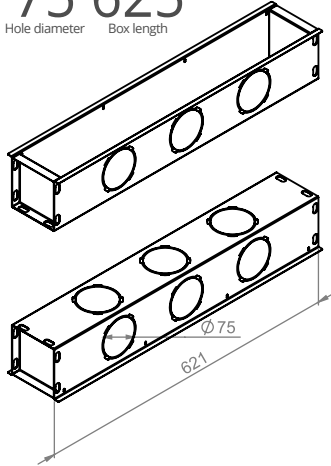

GTG 75 1000

Hole diameter Box length

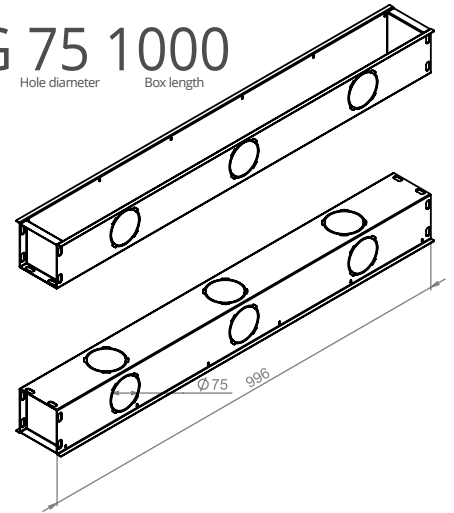

GTG 125 625

Hole diameter Box length

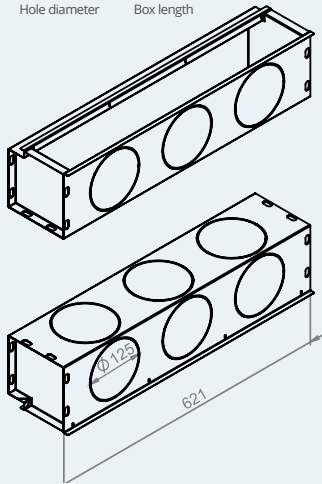

GTG 125 1000

Hole diameter Box length

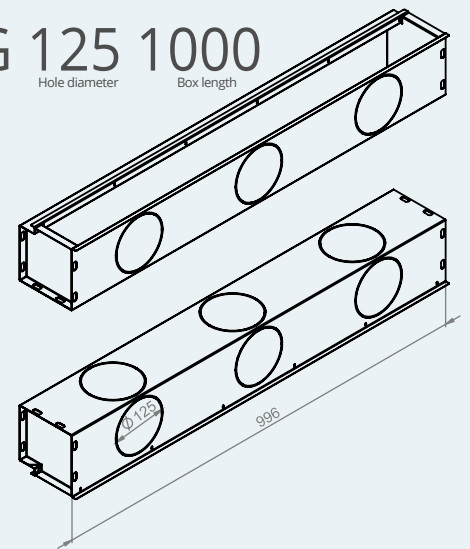

GTG 160 625

Hole diameter Box length

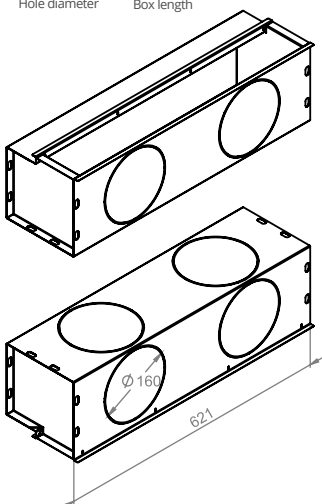

GTG 160 1000

Hole diameter Box length

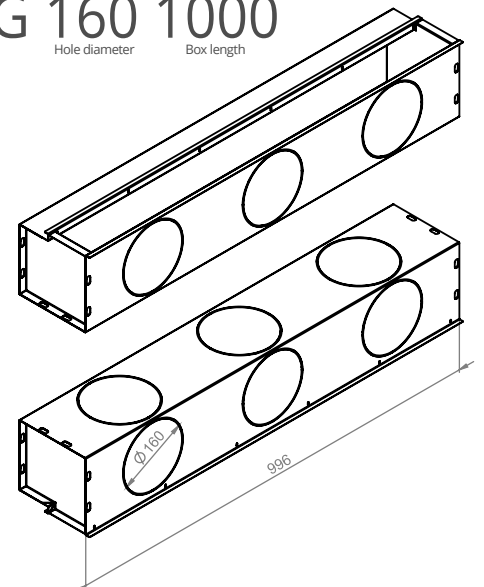

## SUITABLE FOR LINE DIFFUSERS: 1/12, 1/18, 2/12, 2/18

The junction boxes can be ordered with individual dimensions.

GTG 75 1250

Hole diameter Box length

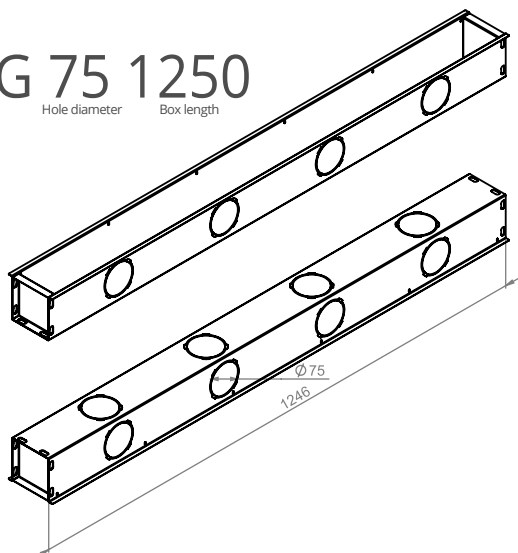

GTG 75

Hole diameter

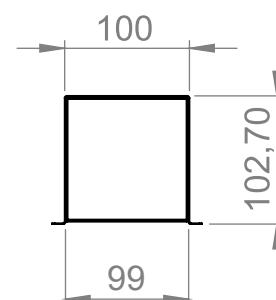

GTG 125 1250

Hole diameter Box length

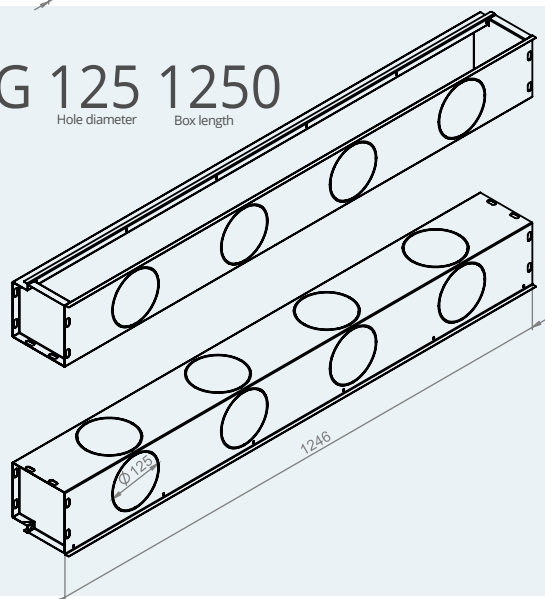

GTG 125

Hole diameter

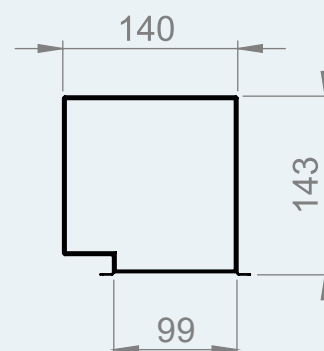

GTG 160 1250

Hole diameter Box length

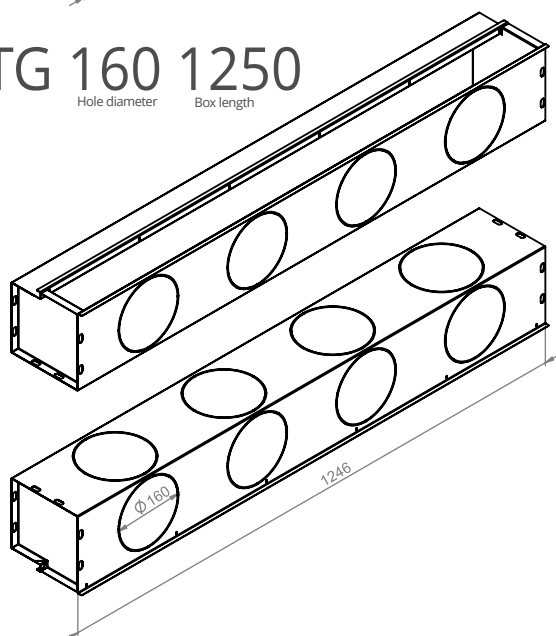

GTG 160

Hole diameter

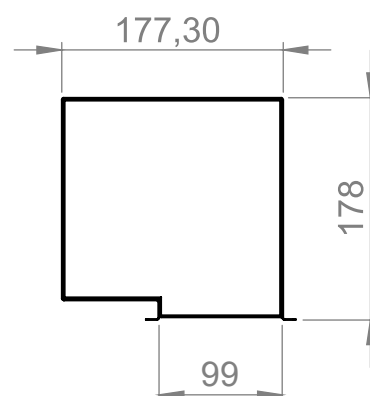

# LINE 3/12

## SLOT DIFFUSER

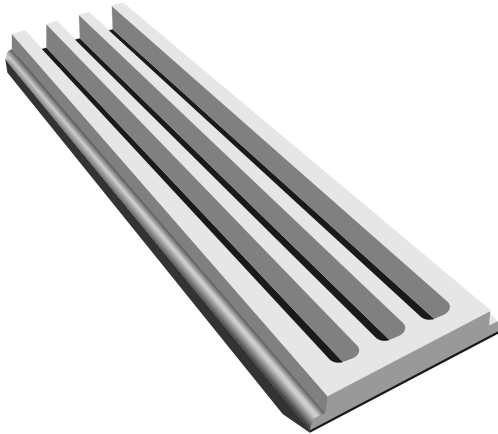

**3**  
AMOUNT OF SLOTS

**12 mm**  
WIDTH OF SLOT

**4.085 kg**  
1 M. LENGTH DIFFUSER WEIGHT  
WITHOUT PACKAGING (NET)

**625 / 1000 / 1250**  
STANDARD SLOT LENGTH (MM)

Steel punched sheet. Distributes the air supply through the diffuser.

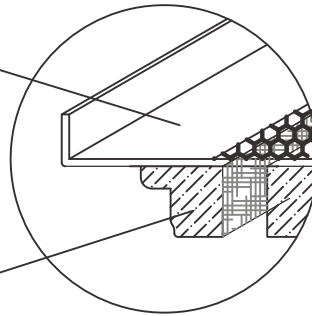

Gypsum mix segment. Sanded, puttied, painted. Suitable for all operations in combination with surface finishing

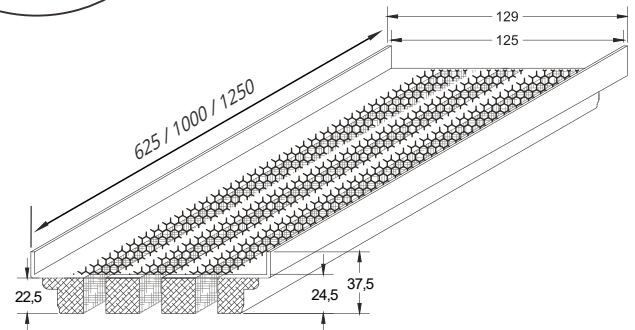
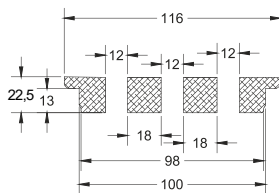

## Airborne noise and resistance, 1 m.

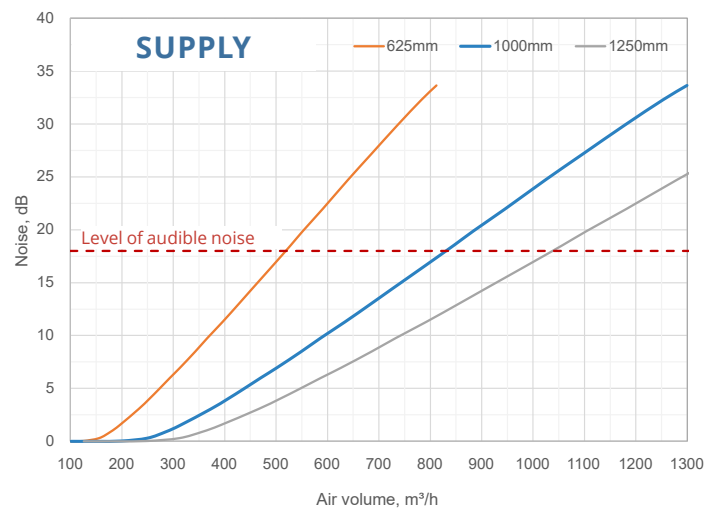
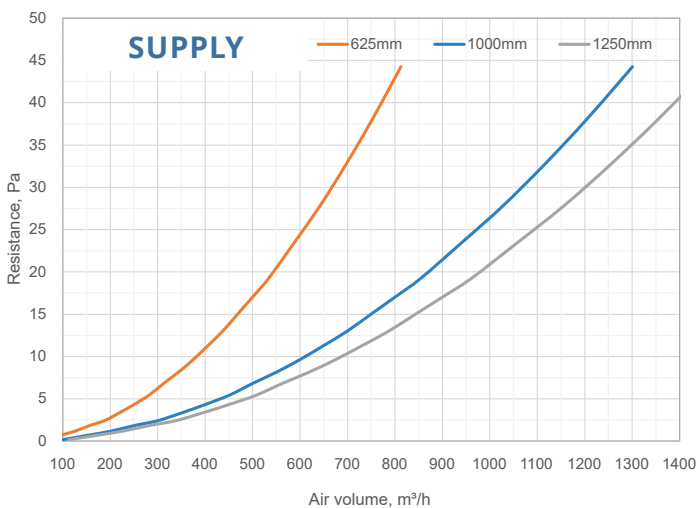



Slim three-slot version with 33% narrower slots, for the most elegant and unintrusive diffuser performance. It harmonises with any interior design, providing comfortable airflow without noise.

## PERCEPTIBLE AIRSPEED $L_{0,2}(m)$ DISTANCE

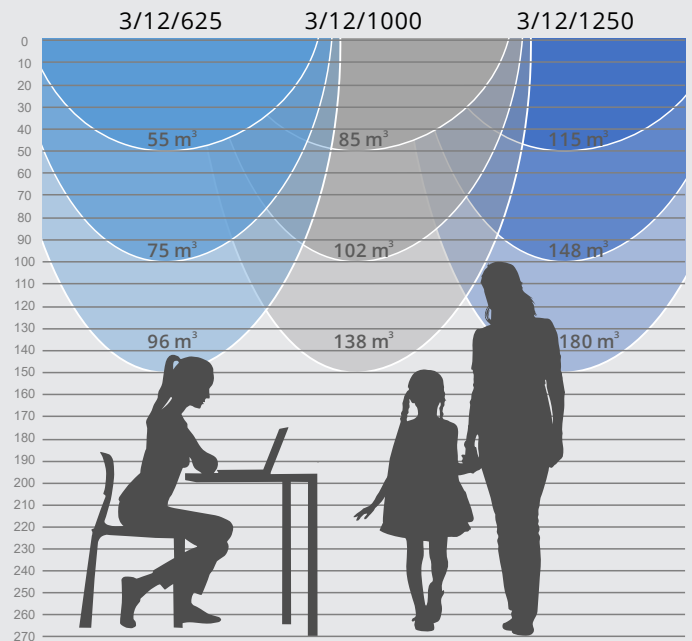

Airflow with Ventmann LINE diffuser at a height of 2.70 m

## PERCEPTIBLE AIRSPEED REACH LIMIT

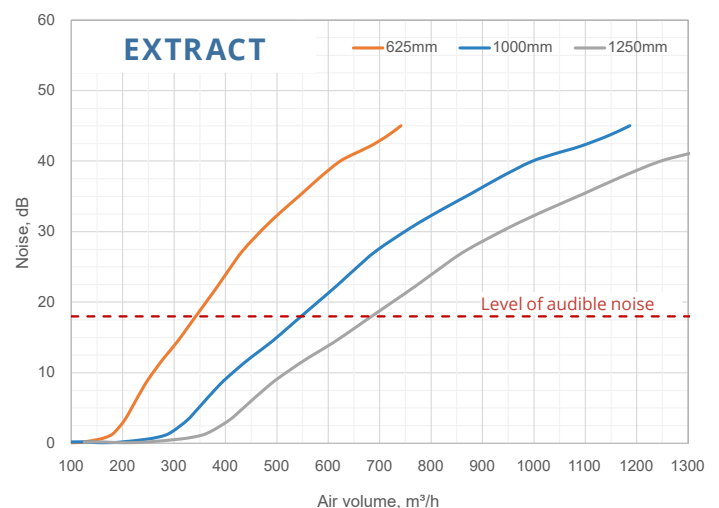
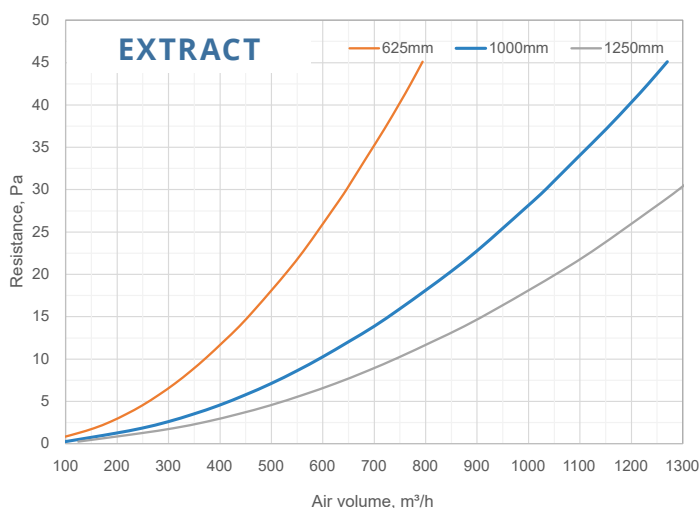
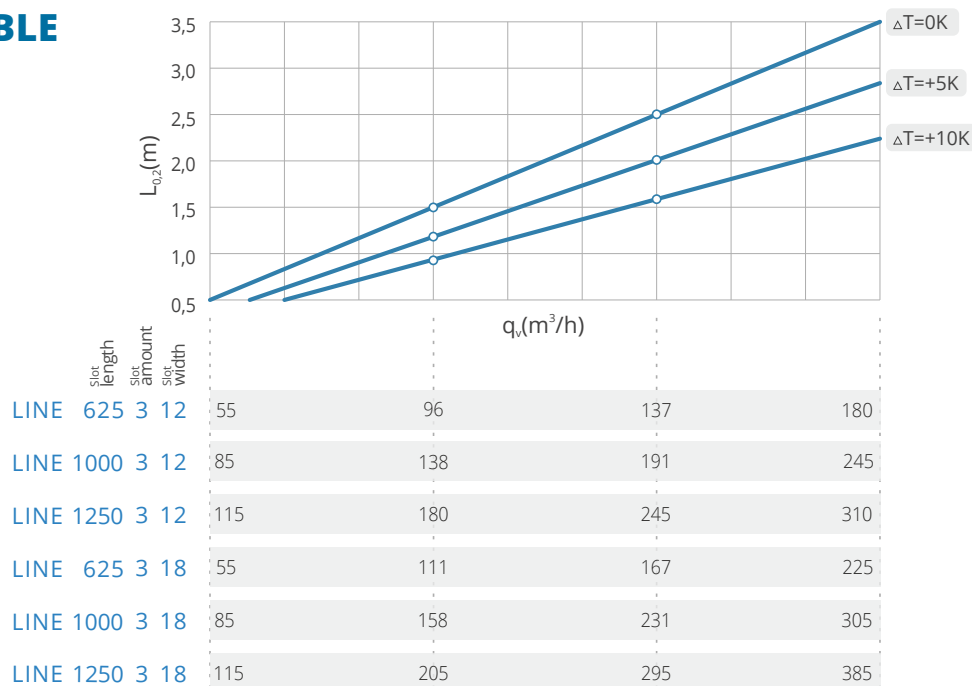

# LINE 3/18

## SLOT DIFFUSER

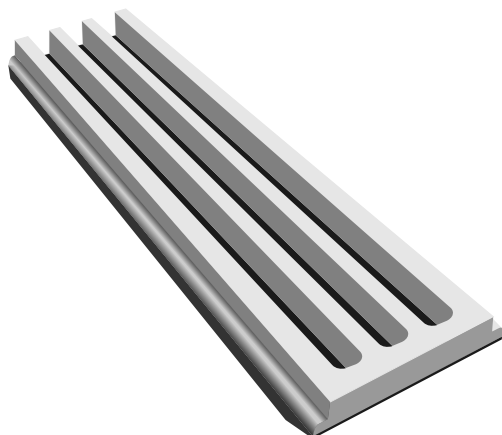

**3**  
AMOUNT OF SLOTS

**18 mm**  
WIDTH OF SLOT

**4.085 kg**  
1 M. LENGTH DIFFUSER WEIGHT WITHOUT  
PACKAGING (NET)

**625 / 1000 / 1250**  
STANDARD SLOT LENGTH (MM)

Steel punched sheet. Distributes the air supply through the diffuser.

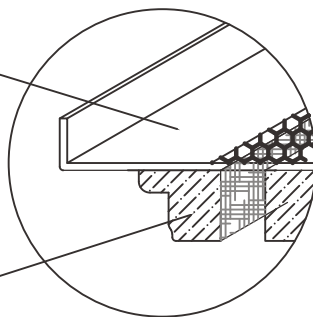

Gypsum mix segment. Sanded, puttied, painted. Suitable for all operations in combination with surface finishing

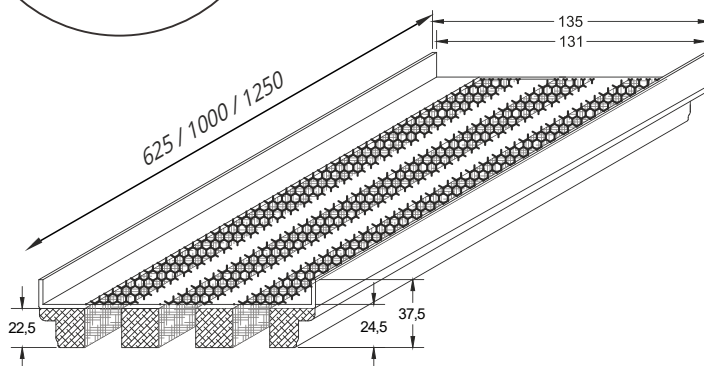
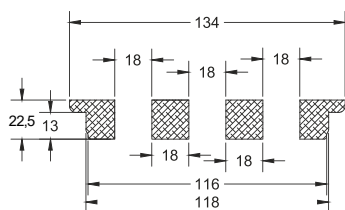

### Airborne noise and resistance, 1 m.

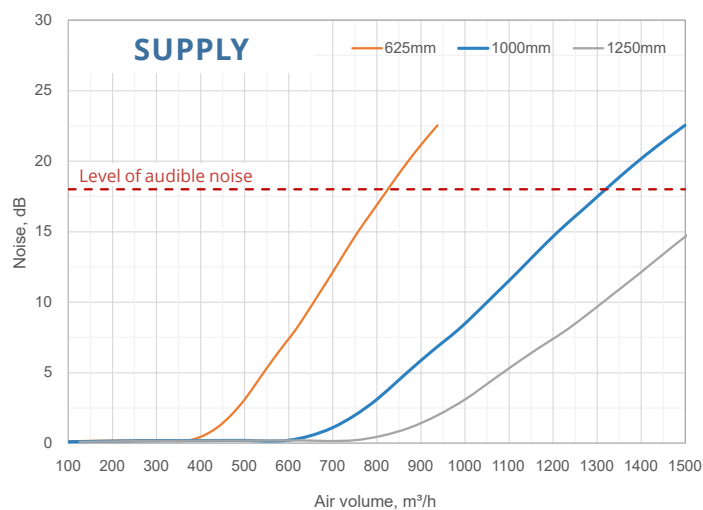
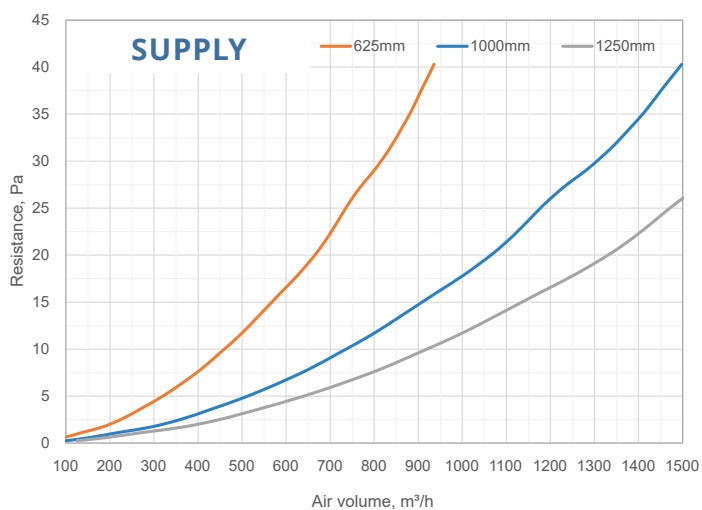

The three-slot diffuser allows the highest air volume of all Ventmann LINE diffusers, making it extremely efficient and a very suitable option for indoor air supply or extract applications. Perfect in applications with variable air volumes.

## PERCEPTIBLE AIRSPEED $L_{0,2}(m)$ DISTANCE

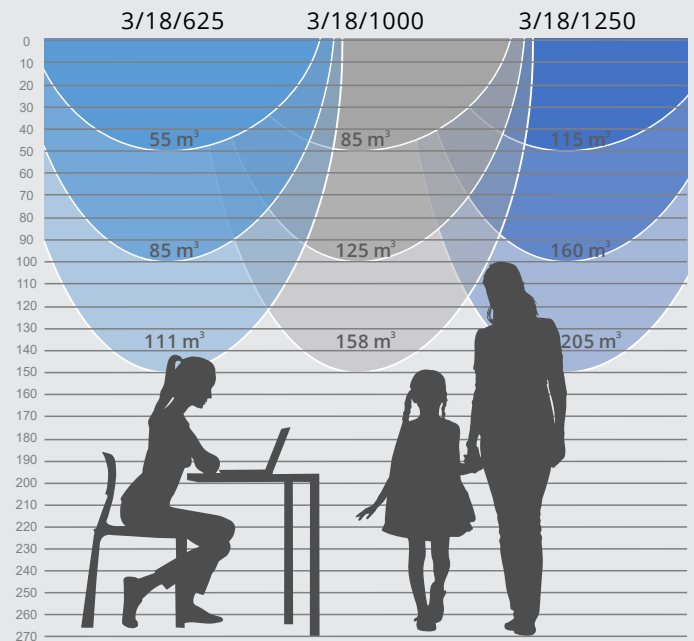

Airflow with Ventmann LINE diffuser at a height of 2.70 m

## PERCEPTIBLE AIRSPEED REACH LIMIT

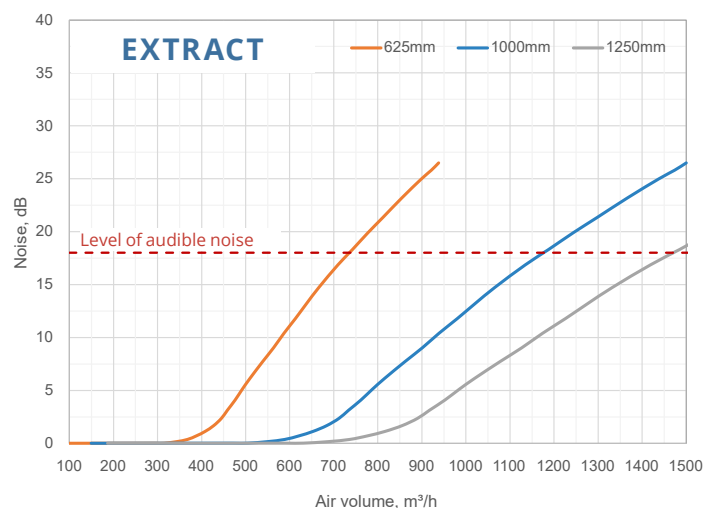
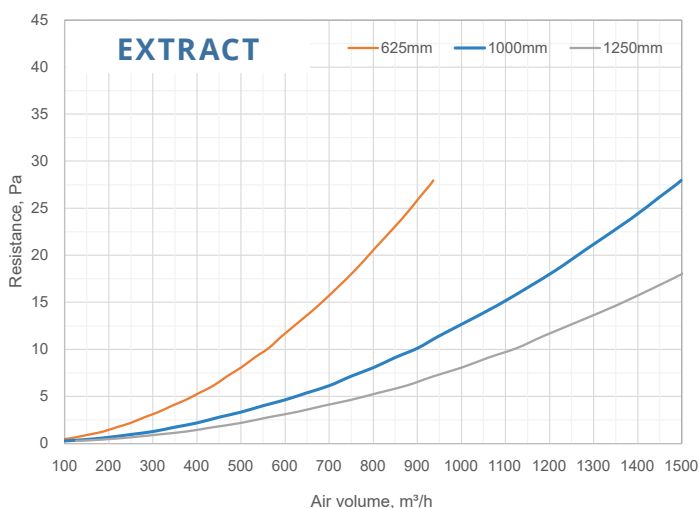
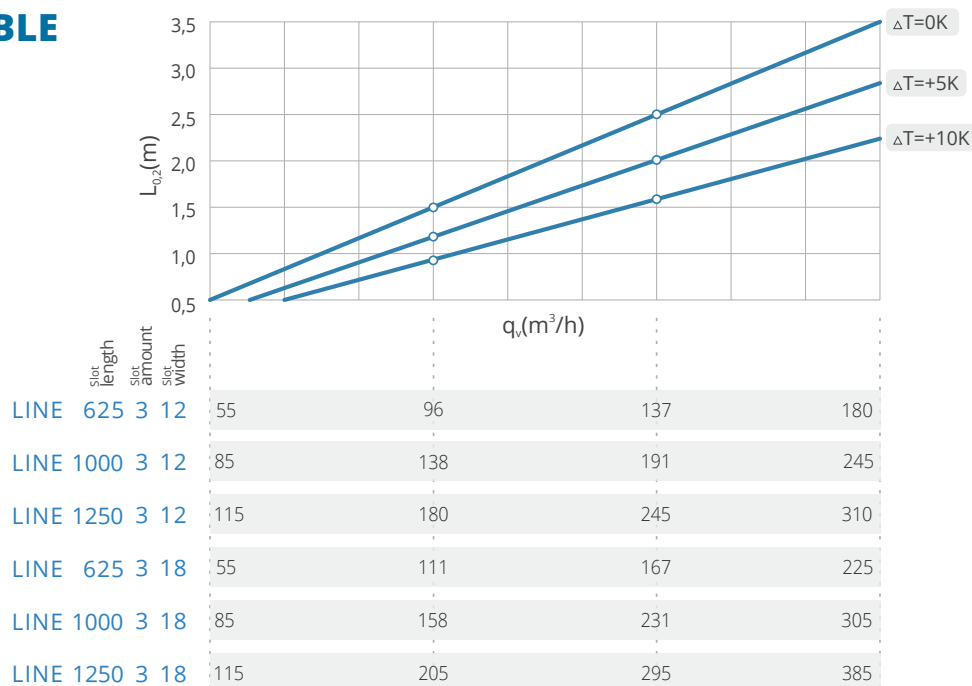

# STANDARD ACOUSTIC BOXES

GTG 3 125 625

Hole diameter Box length

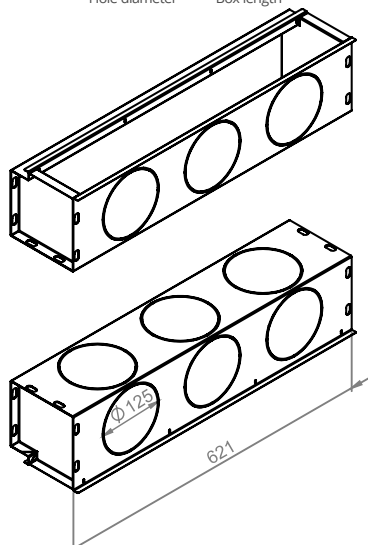

GTG 3 125 1000

Hole diameter Box length

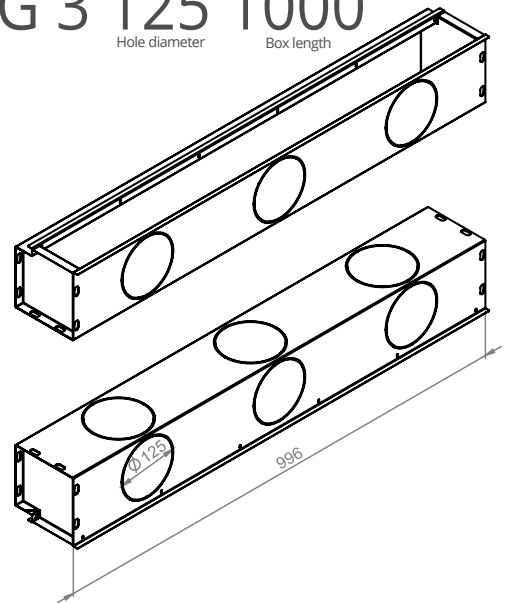

GTG 3 160 625

Hole diameter Box length

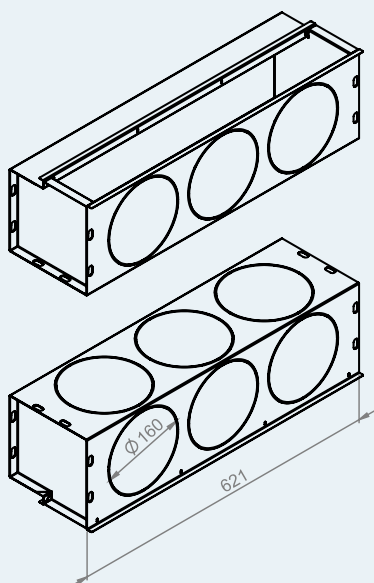

GTG 3 160 1000

Hole diameter Box length

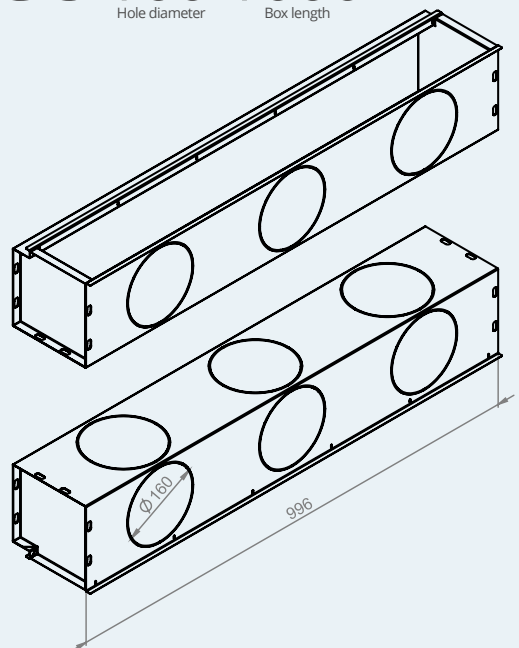



## SUITABLE FOR LINE DIFFUSERS: 3/12, 3/18

The junction boxes can be ordered with individual dimensions.

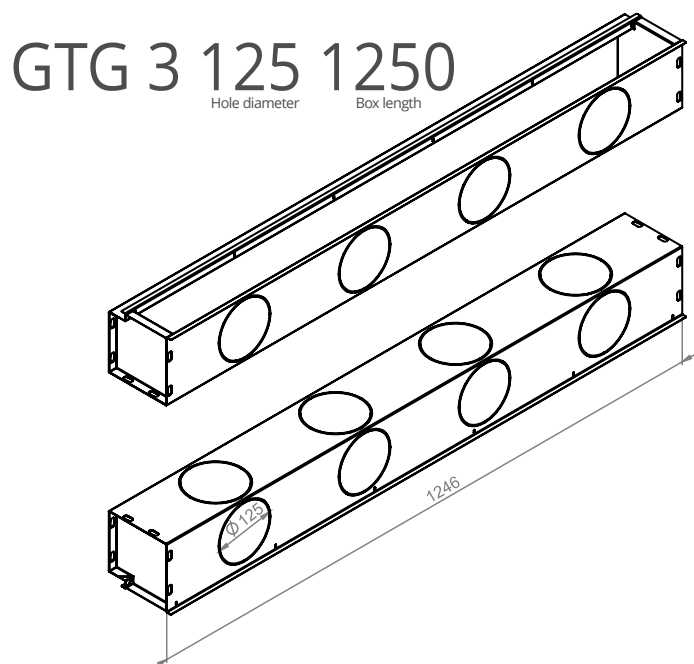

GTG 3 125

Hole diameter

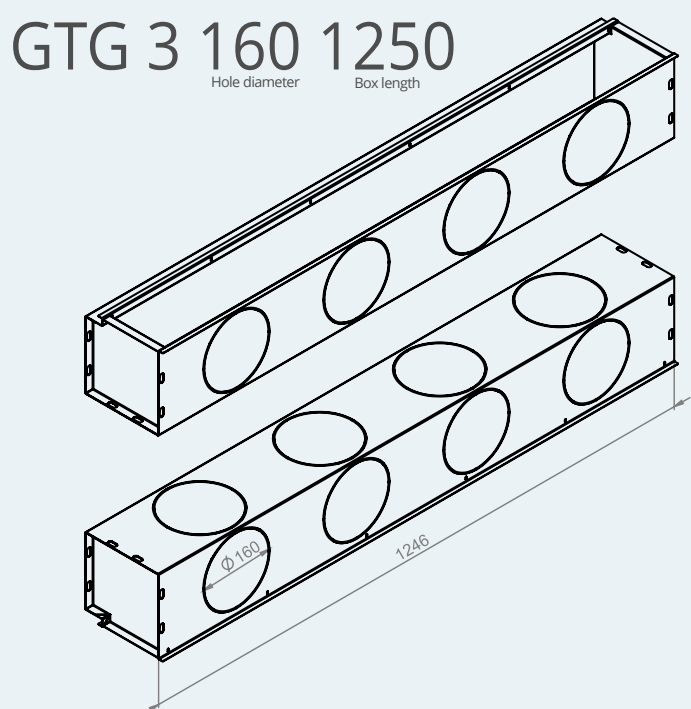
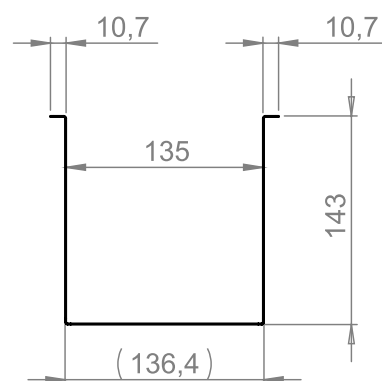

GTG 3 160

Hole diameter

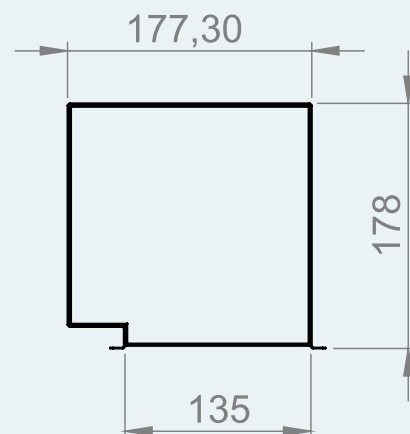

# CIRCLE







Ventmann CIRCLE diffusers are the most versatile solution for every room and interior design style. They are our most popular product, offering excellent design flexibility and blending perfectly with the surrounding décor. Multiple CIRCLE diffusers are often installed in a single room, creating refreshingly modern designs.

Like all Ventmann air diffusers, CIRCLE diffusers create a durable bond with the surrounding plasterboard wall or the ceiling and can be painted and finished exactly the same as the surrounding surface.

## SELECTION

Ventmann CIRCLE diffusers are available in:

- Small — 100mm or 125mm connection diameter
- Medium — 160mm connection diameter
- Large — 200mm or 250mm connection diameter

Multiple CIRCLE diffusers can be installed in a single room.

## INSTALLATION

CIRCLE diffusers are designed to be easy to install. Simply insert into place, fill in the gap, and finish the wall or ceiling as normal.

Detailed instructions are provided with every order.

## ORDERING DETAILS

To order Ventmann CIRCLE diffusers, please visit our website.

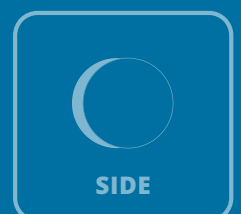
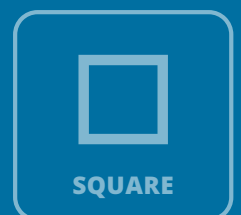
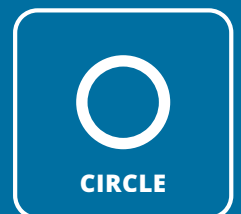
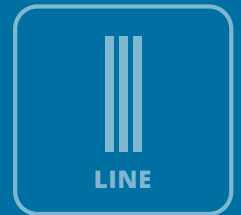

Ventmann — your choice of air elegance.

# CIRCLE 100/125

## ROUND DIFFUSER



100/125 mm

DIAMETER OF COUPLING SLEEVE

2.60 kg

WEIGHT WITHOUT PACKAGING (NET)

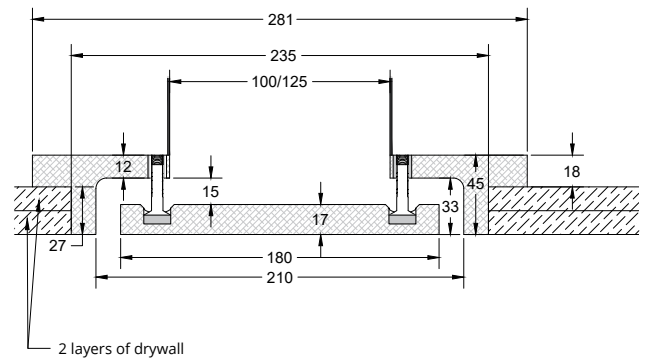
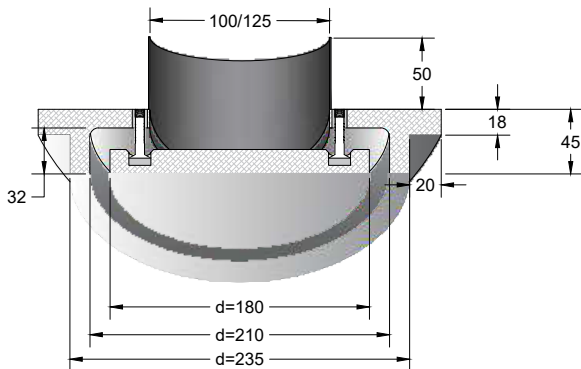

### Airborne noise and resistance, 1 m.

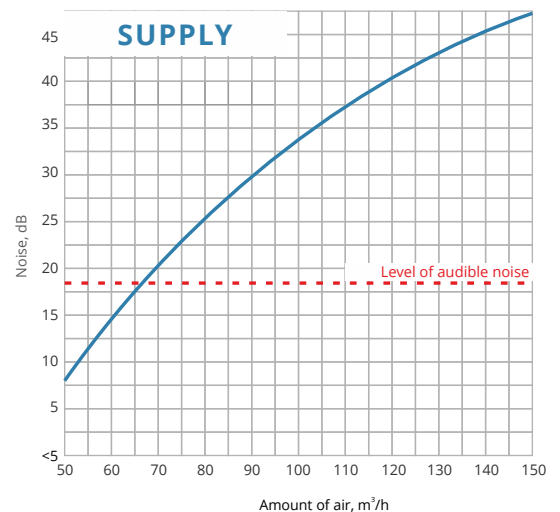
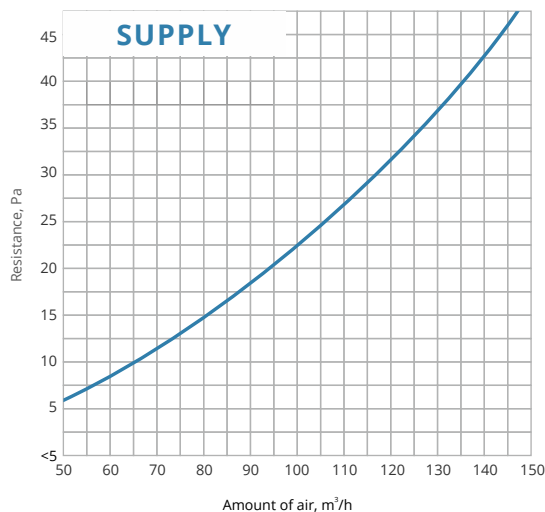



Our CIRCLE diffuser can be used in rooms of many different sizes, both for air supply and air extraction.

## SENSIBLE AIRFLOW

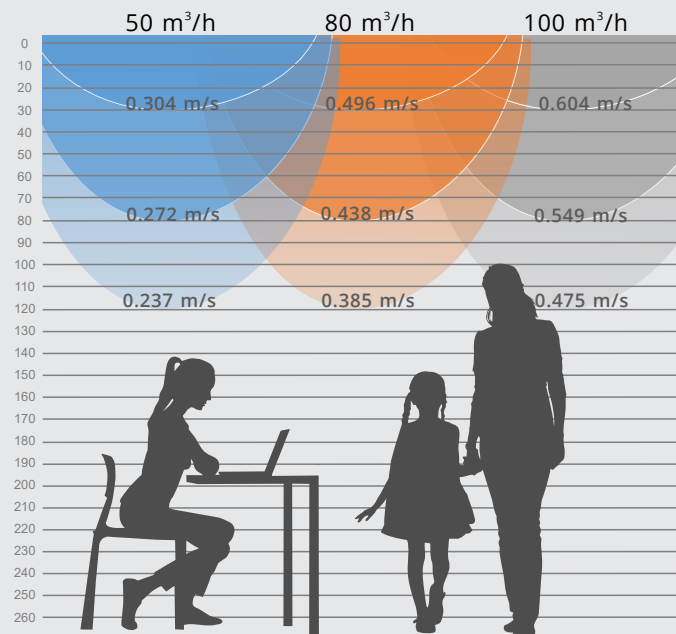

Airflow with Ventmann CIRCLE diffuser at a height of 2.70 m

## Air velocity at distance from diffuser

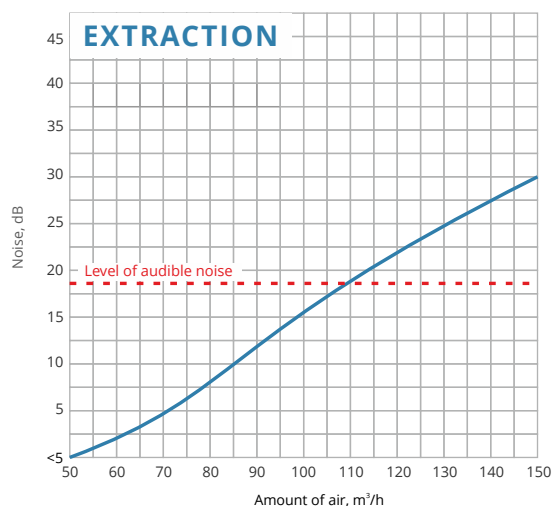
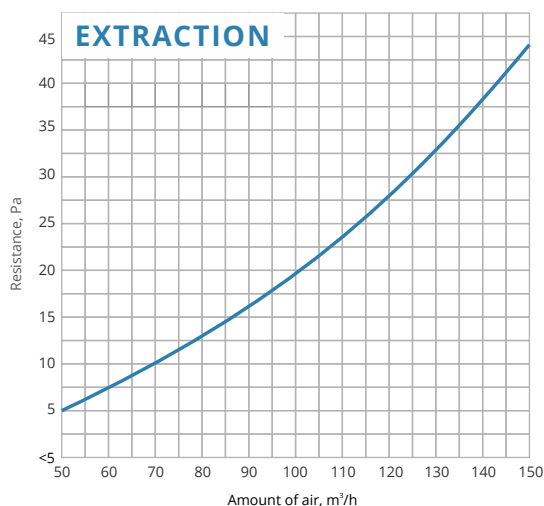
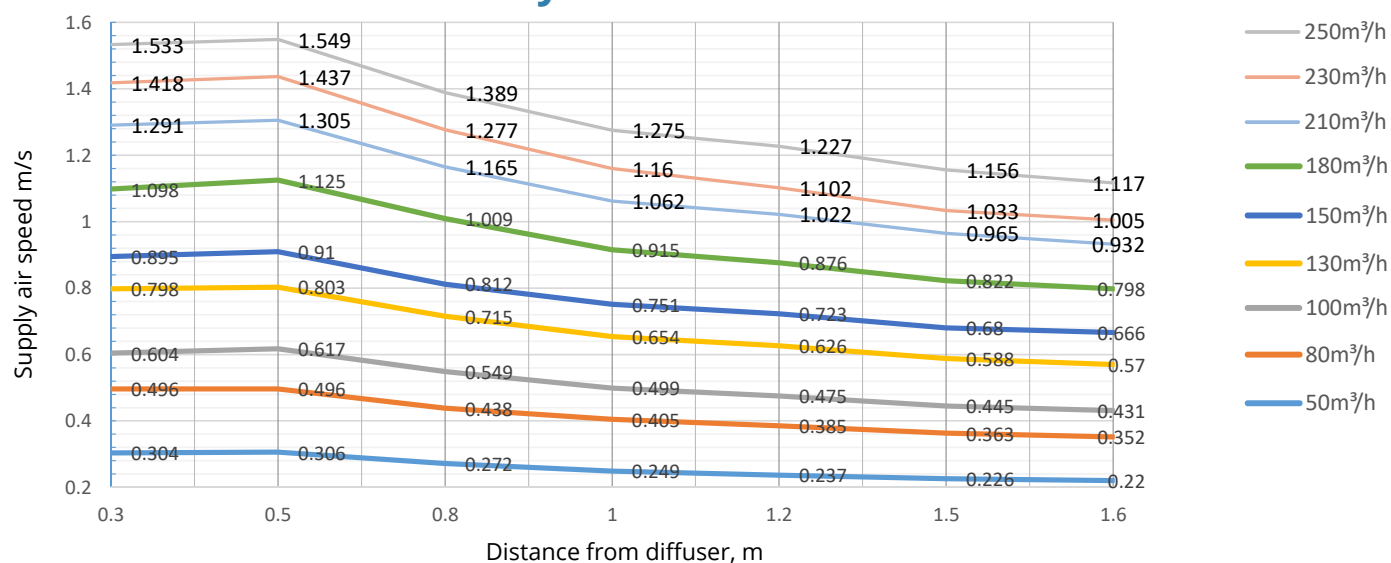

# CIRCLE 160

## ROUND DIFFUSER



160 mm

DIAMETER OF COUPLING SLEEVE

3.20 kg

WEIGHT WITHOUT PACKAGING (NET)

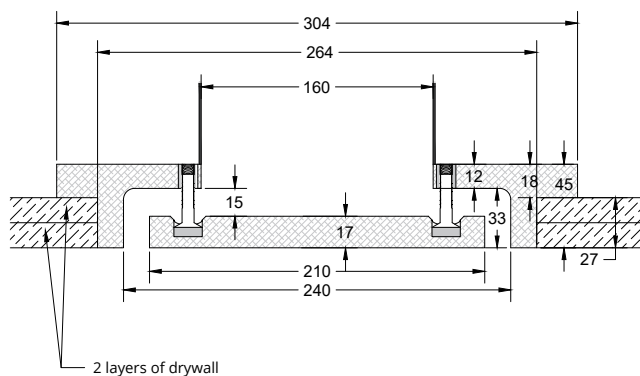
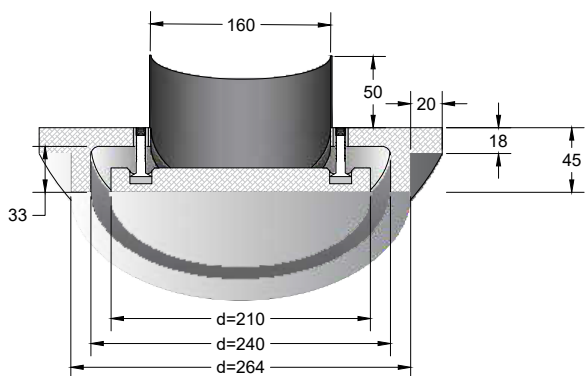

### Airborne noise and resistance, 1 m.

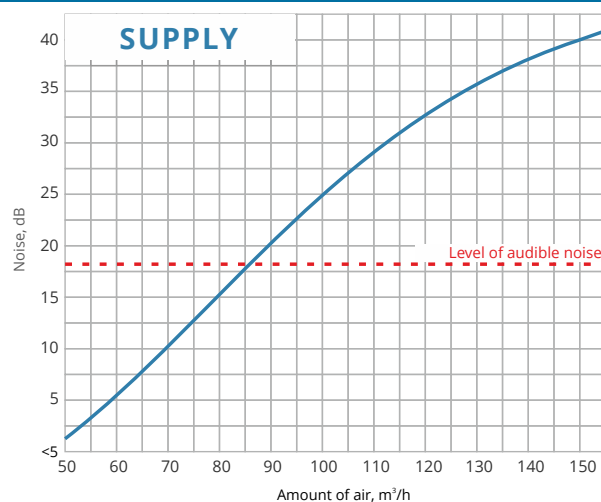
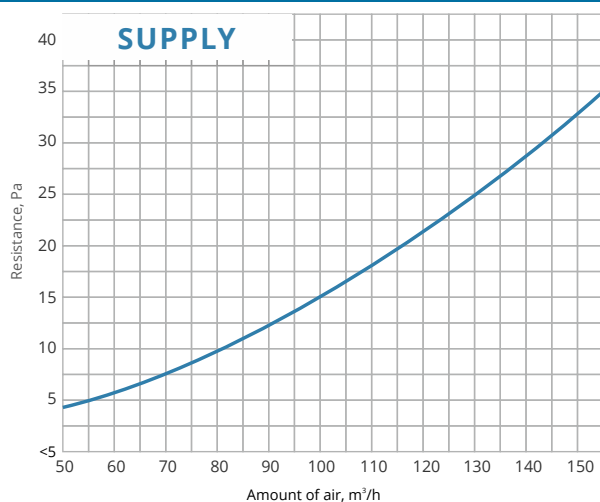

Our CIRCLE diffuser can be used in rooms of many different sizes, both for air supply and air extraction.

## SENSIBLE AIRFLOW

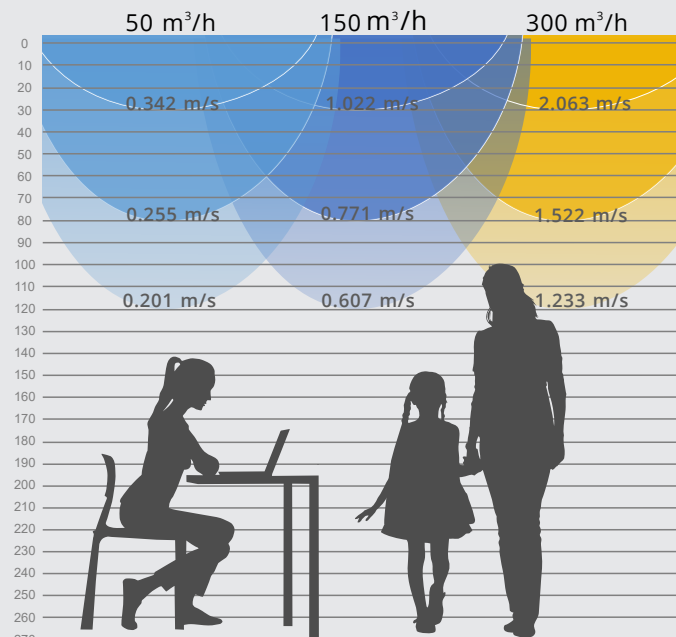

Airflow with Ventmann CIRCLE diffuser at a height of 2.70 m

## Air velocity at distance from diffuser

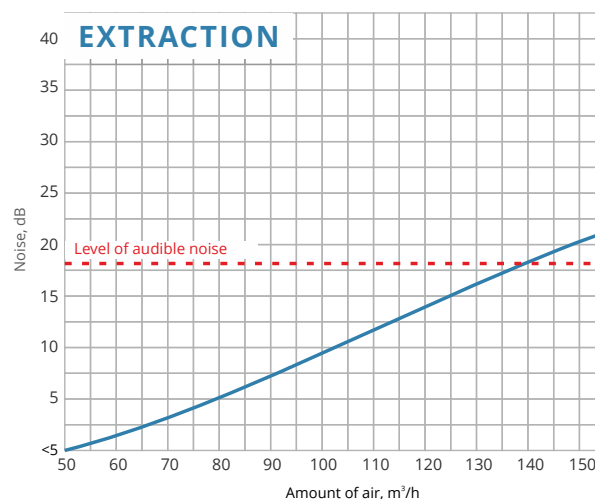
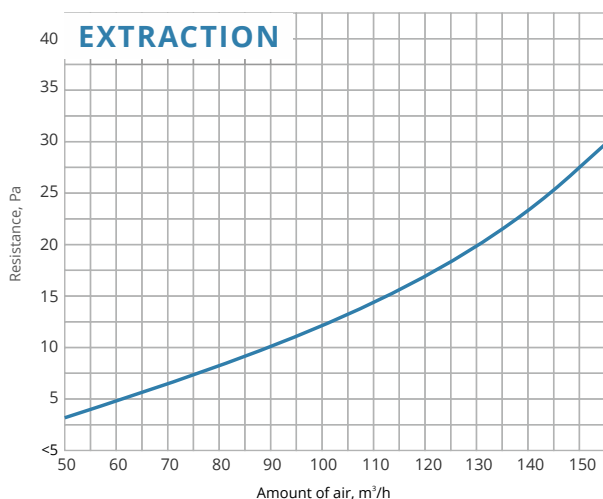
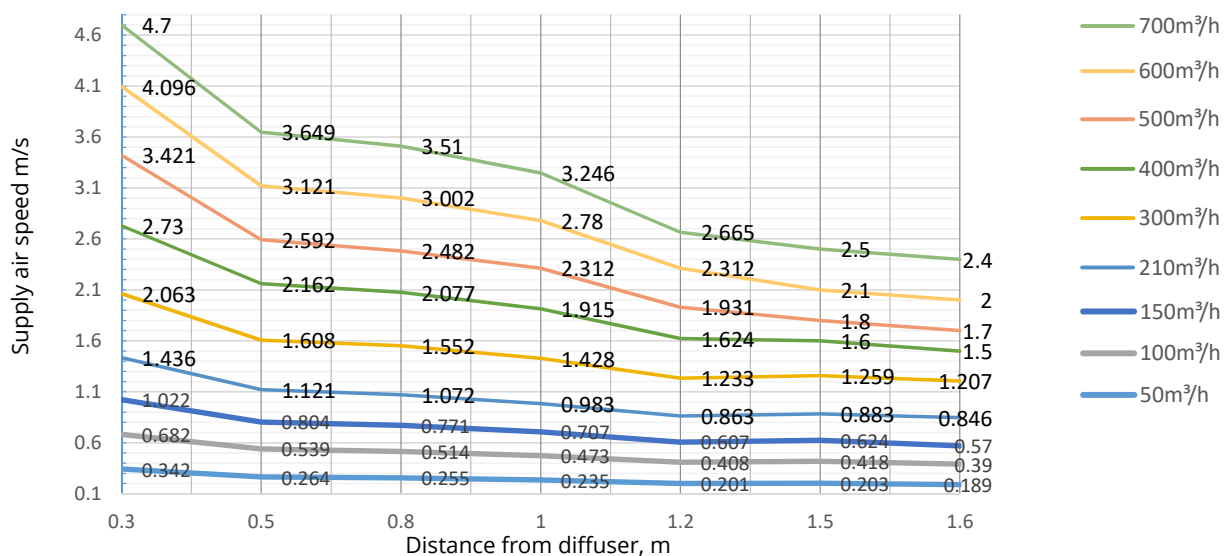

# CIRCLE 200/250

## ROUND DIFFUSER



200/250 mm

DIAMETER OF COUPLING SLEEVE

3.90 kg

WEIGHT WITHOUT PACKAGING (NET)

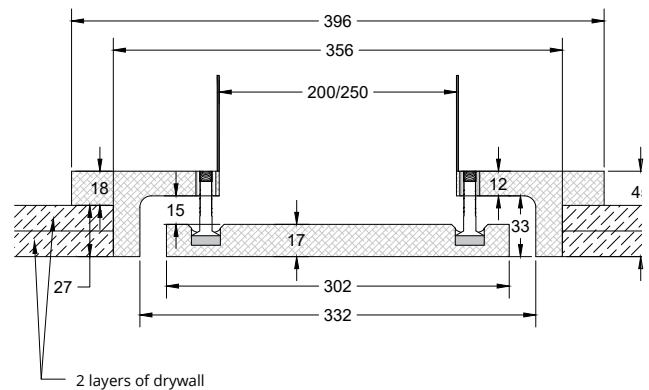
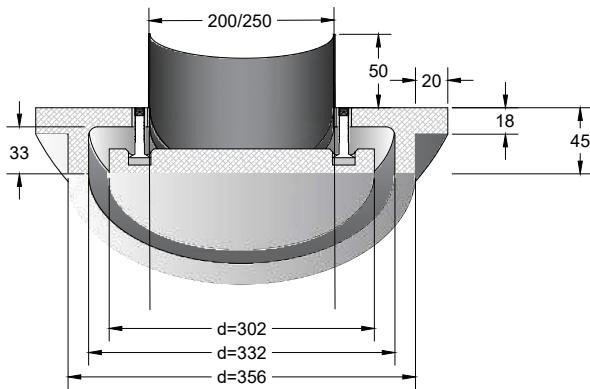

### Airborne noise and resistance, 1 m.

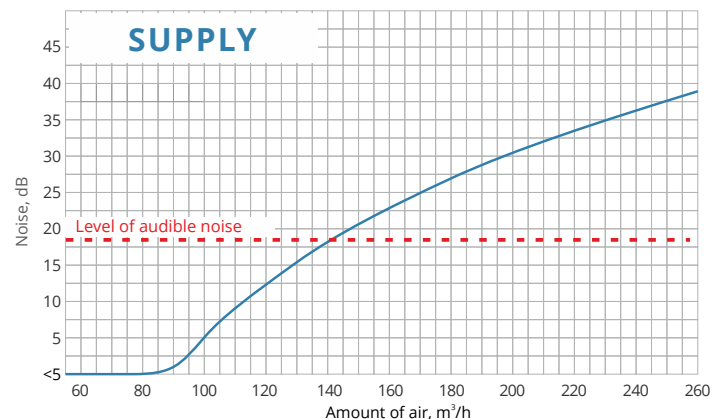
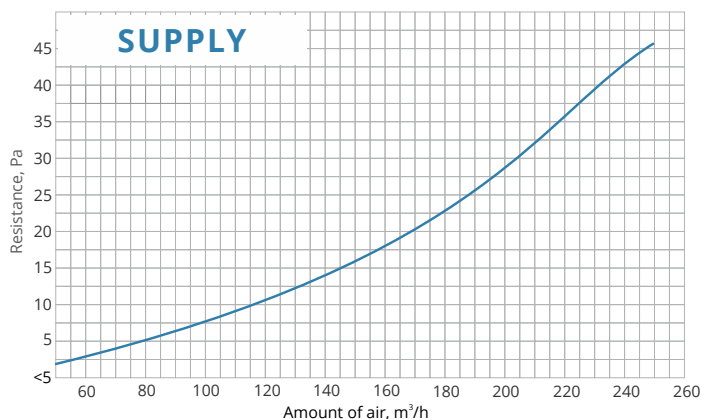

Our CIRCLE diffuser can be used in rooms of many different sizes, both for air supply and air extraction.

## SENSIBLE AIRFLOW

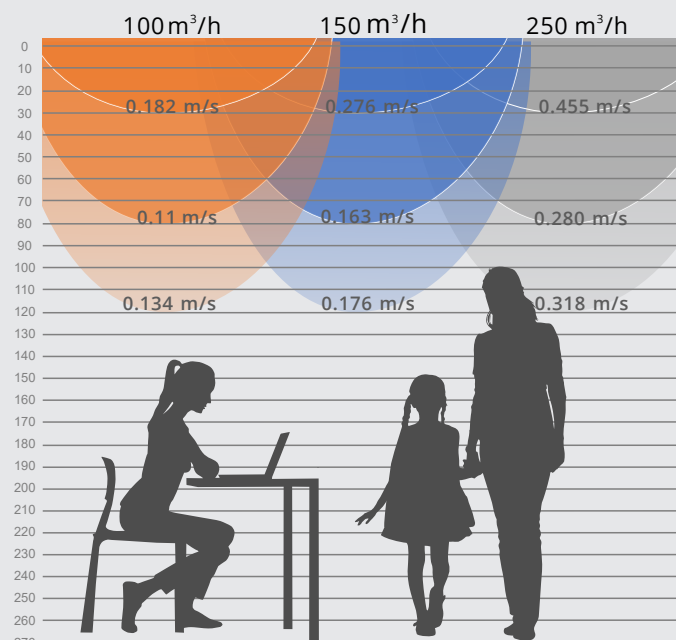

Airflow with Ventmann CIRCLE diffuser at a height of 2.70 m

## Air velocity at distance from diffuser

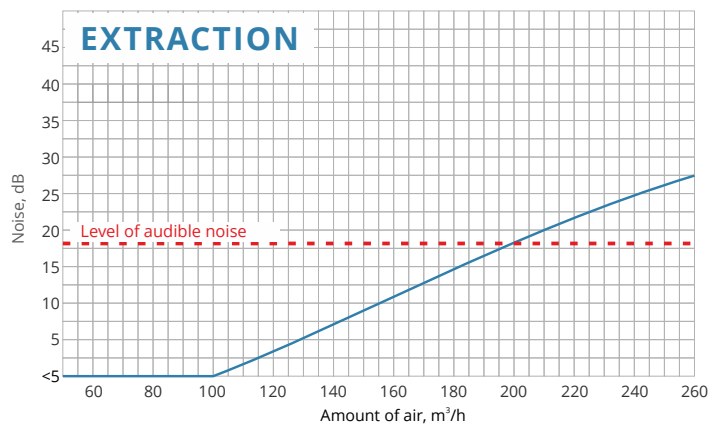
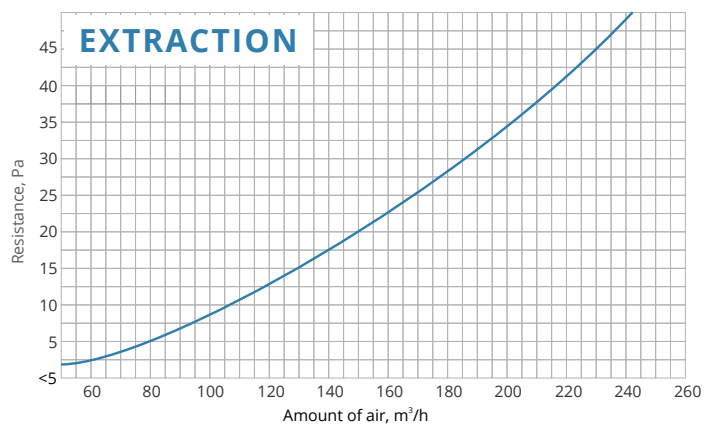
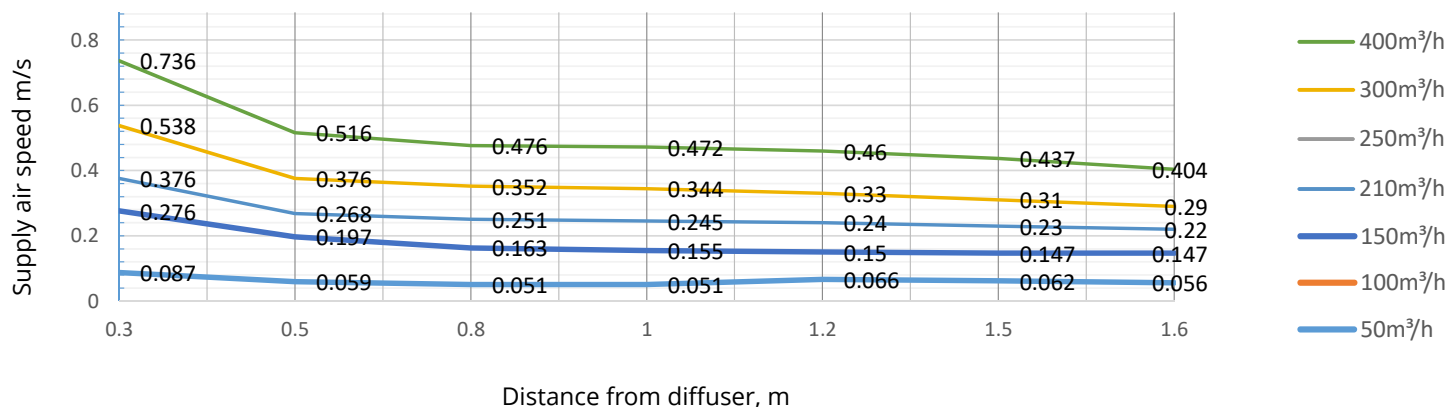

# SQUARE







Ventmann SQUARE diffusers are so much more than just another air distributor. They are minimalist interior design elements that will accentuate the precise lines and angles of a room. Once mounted on a plasterboard wall or ceiling, SQUARE diffusers can be finished and painted just like the surrounding surfaces. You no longer need to hide unsightly ventilation grilles: with Ventmann SQUARE diffusers, air distribution can be an aesthetic part of the design.

## SELECTION

Ventmann SQUARE diffusers are available in:

- 100mm or 125mm connection diameter
- Industrial strengths magnets — the diffuser cap is supported by magnets that do not lose their strength for 95 years

Multiple SQUARE diffusers can be installed in a single room.

## ORDERING DETAILS

To order Ventmann SQUARE diffusers, please visit our website.

Ventmann – your choice of air elegance.

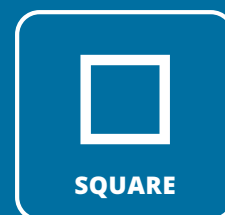
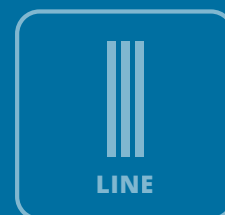

Ventmann — your choice of air elegance.

# SQUARE 100/125

SQUARE SLOT

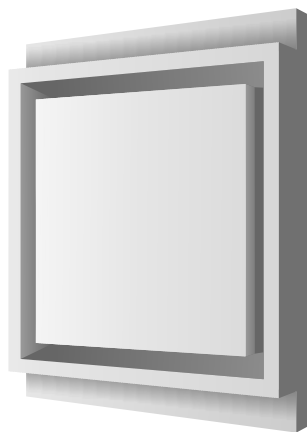

100/125 mm

DIAMETER OF COUPLING SLEEVE

2.40 kg

WEIGHT WITHOUT PACKAGING (NET)

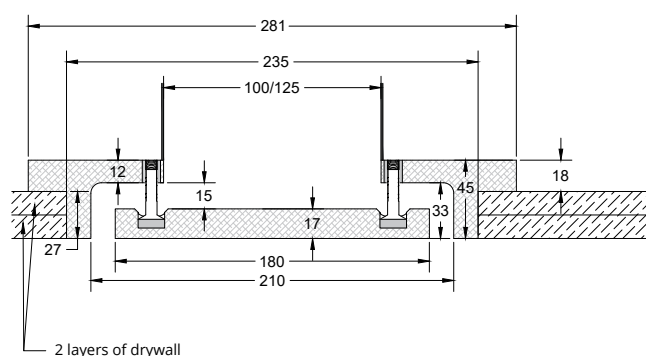
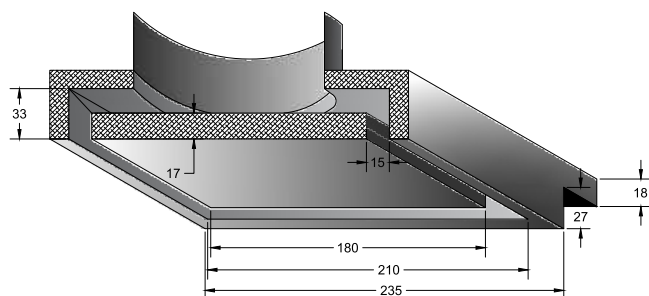

## Airborne noise and resistance, 1 m.

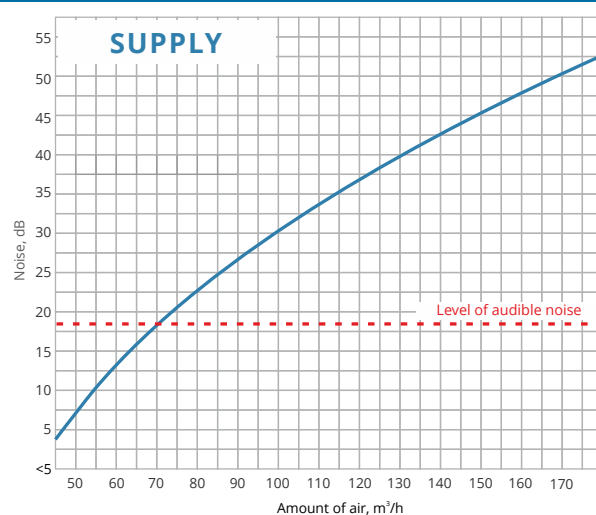
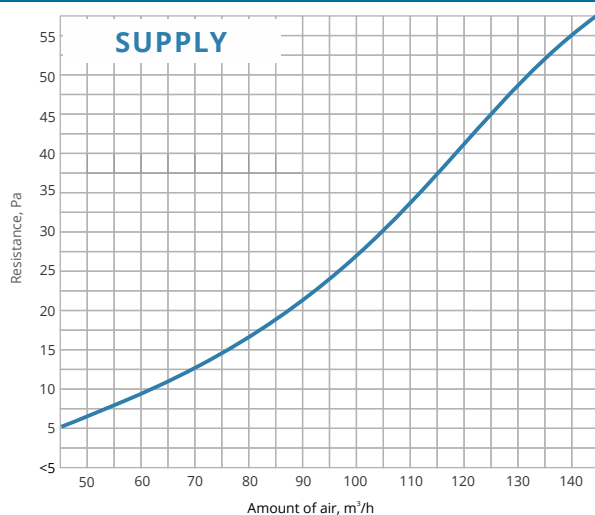

Ventmann SQUARE frameless diffusers are ideal for any room size, as they can be installed individually or in clusters as required. Suitable for both air supply and air extract and can be manufactured with a 100 mm connection pipe.

## SENSIBLE AIRFLOW

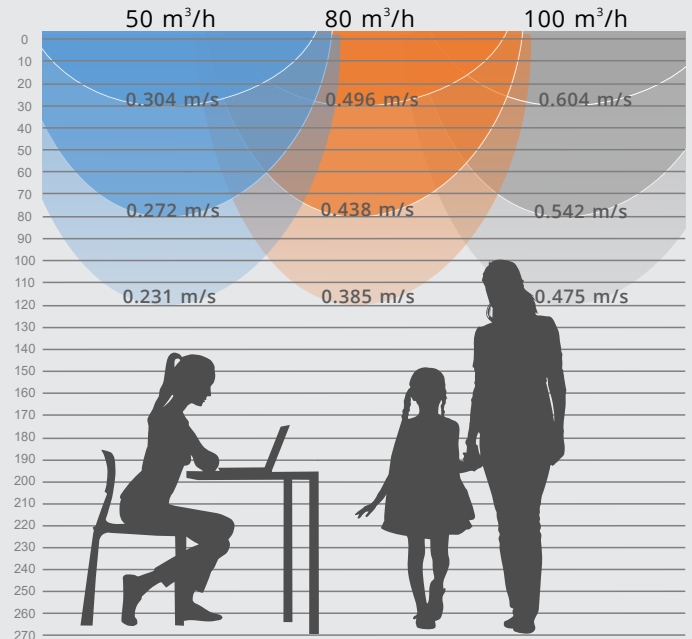

Airflow with Ventmann SQUARE diffuser at a height 2.70 m

## Air velocity at distance from diffuser

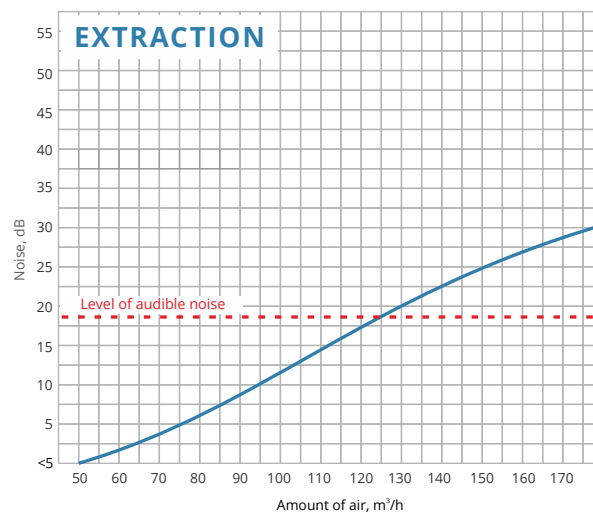
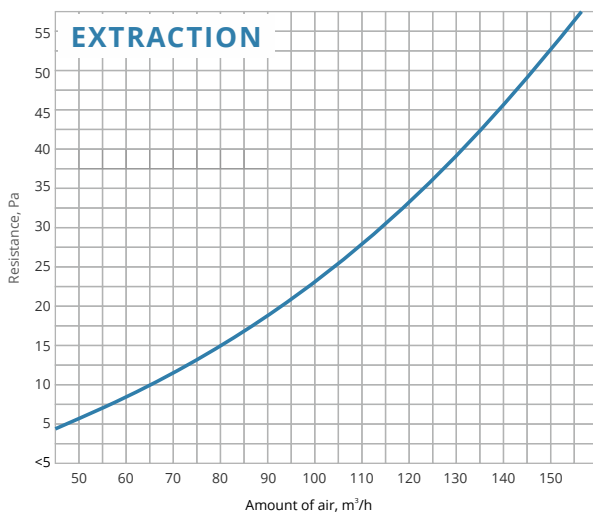
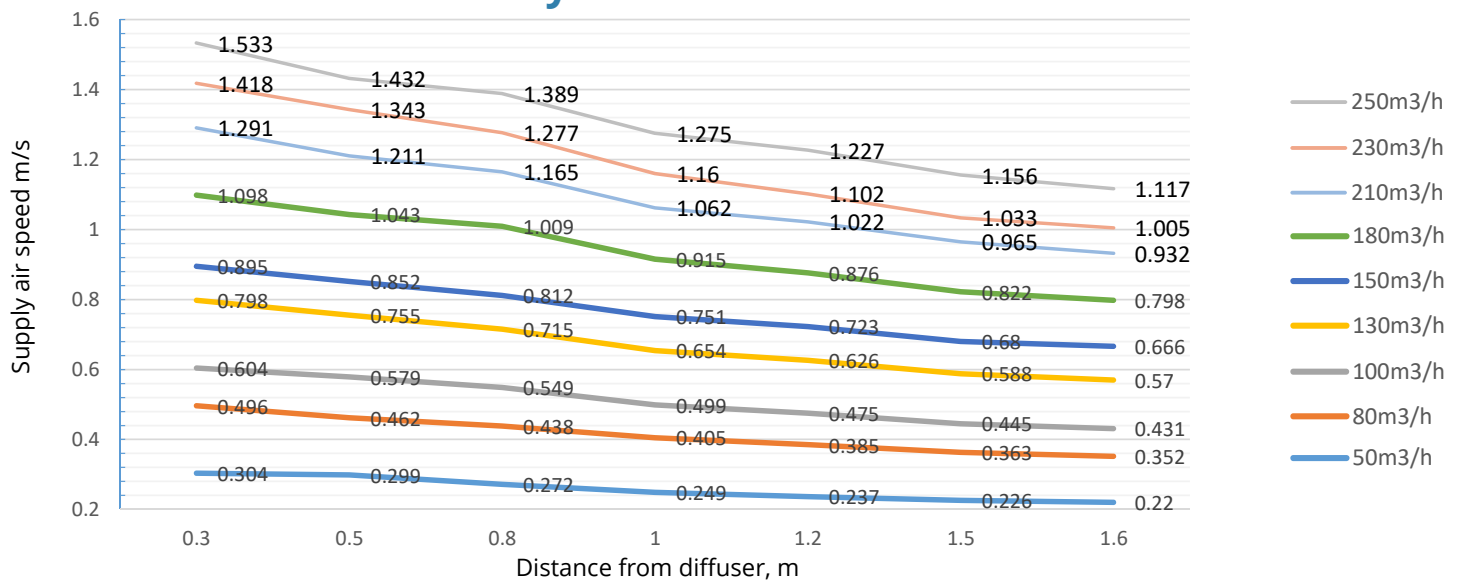

# SIDE





Ventmann SIDE diffusers are aesthetic wall-mounted diffusers designed to beautifully complement your interior design. The unique design of SIDE diffusers allows them to provide comfortable airflow around the area where they are mounted without any unsightly elements that can spoil your design vision. Like all Ventmann diffusers, SIDE diffusers can be plastered and painted together with the entire surface, leaving no frames or gaps between the diffuser and the wall or ceiling.

## SELECTION

Ventmann SIDE diffusers are available in:

- Round or square cap shape – to adapt the SIDE diffuser to your design requirements
- Small: 100mm or 125mm connection diameter
- Medium: 160mm connection diameter
- Large: 200mm or 250mm connection diameter
- Multiple SIDE diffusers can be installed in a single room.

## ORDERING DETAILS

To order Ventmann SQUARE diffusers, please visit our website.

Ventmann – your choice of air elegance.

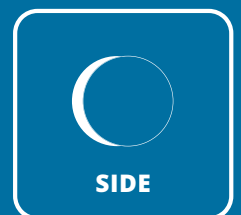
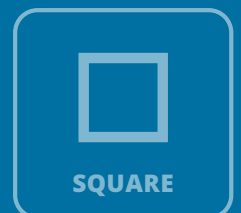
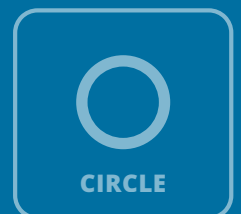
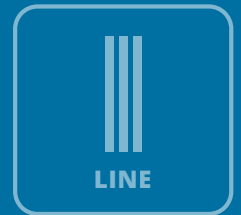

Ventmann — your choice of air elegance.

# SIDE 100/125

## WALL DIFFUSER

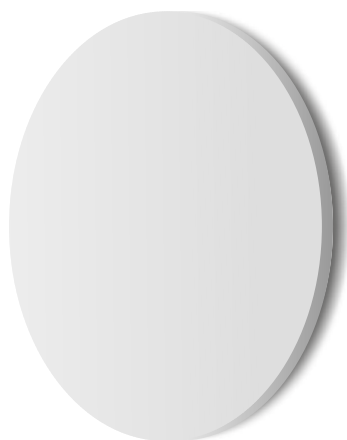

SIDE ROUND

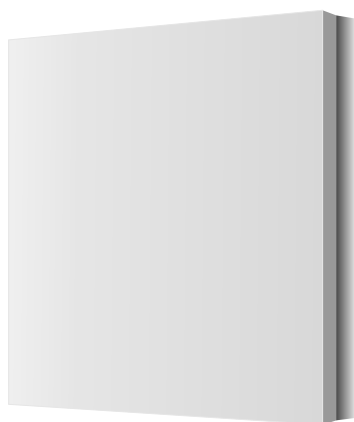

SIDE SQUARE

100/125 mm

DIAMETER OF COUPLING SLEEVE

2.735 kg

WEIGHT WITHOUT PACKAGING (NET)

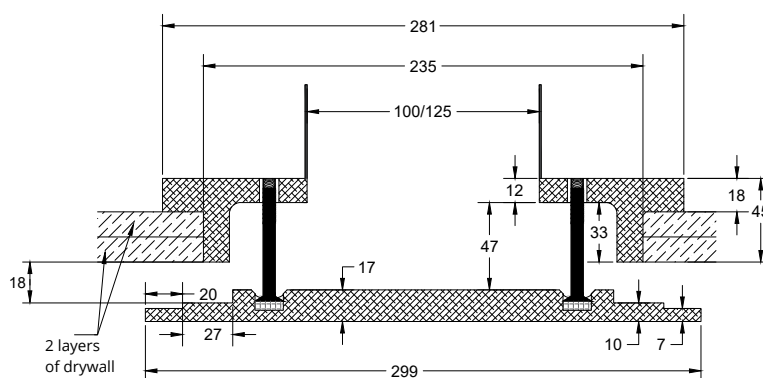
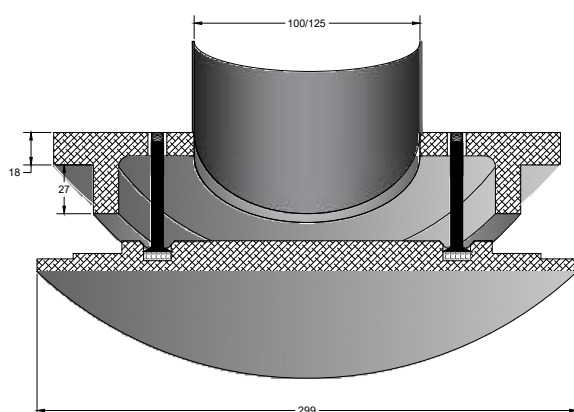

## Airborne noise and resistance, 1 m.

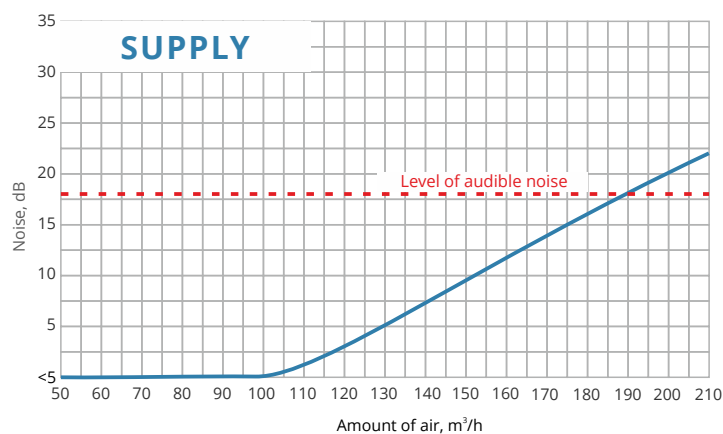
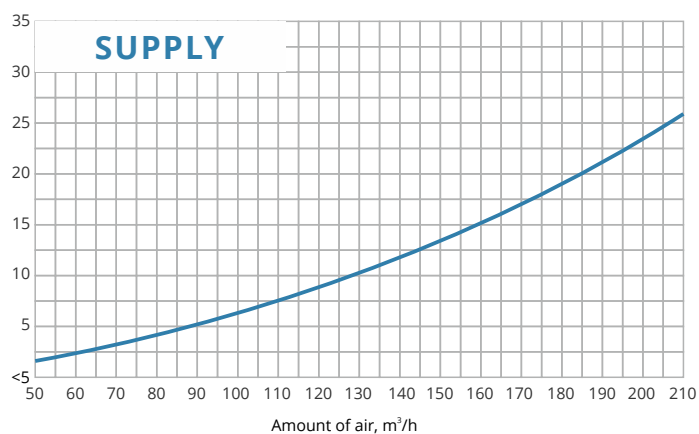



Due to its unique design, the SIDE diffuser distributes air horizontally when installed in the ceiling or vertically when installed on a wall, allowing it to provide comfortable airflow to occupants even when mounted above seating or desks.

## SENSIBLE AIRFLOW

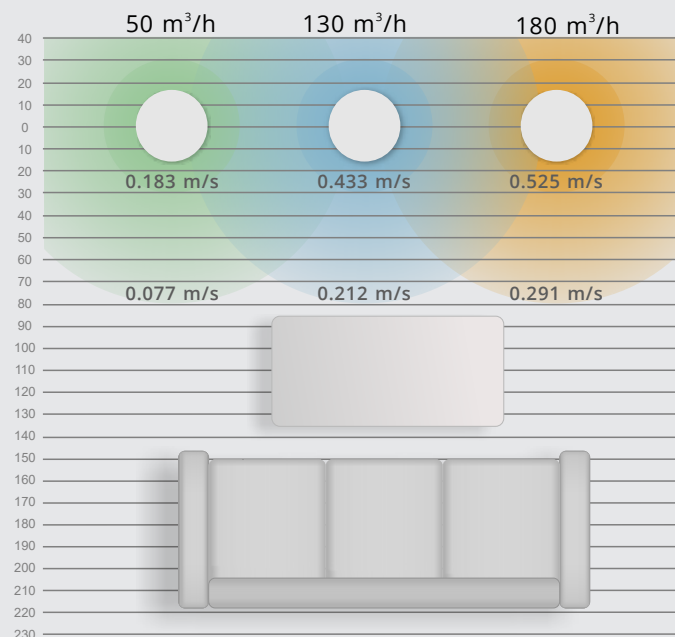

Airflow perceptible with Ventmann SIDE diffuser in the ceiling (top view)

## Air velocity at distance from diffuser

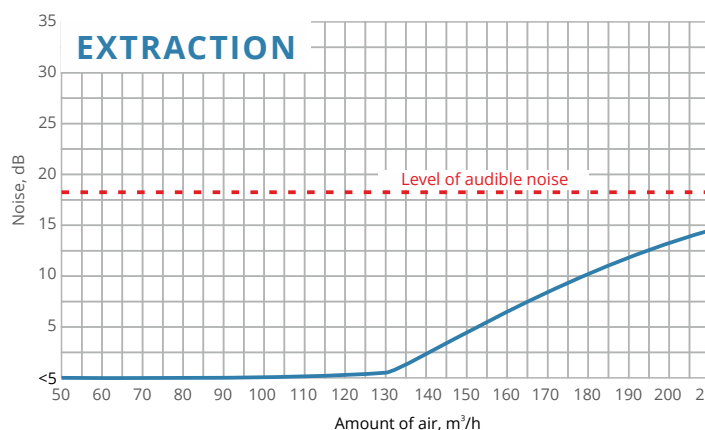
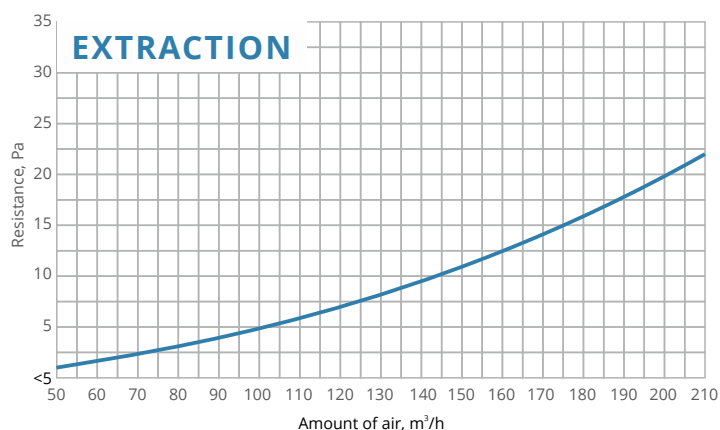
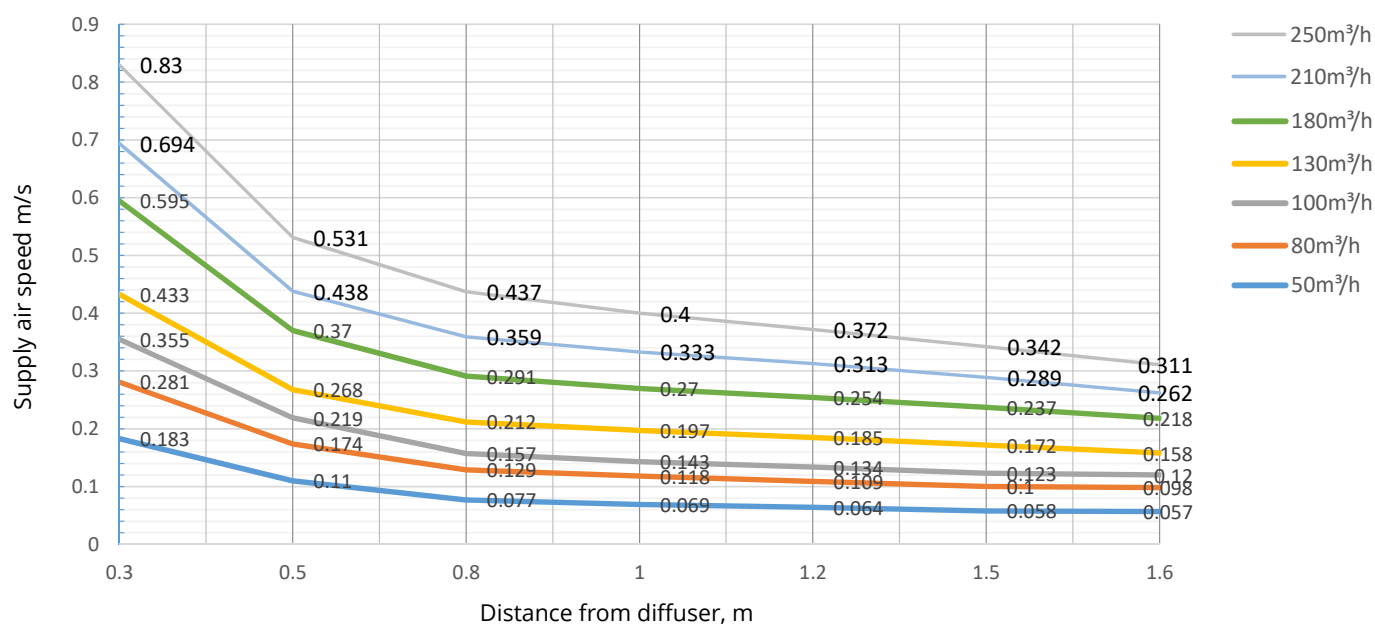

# SIDE 160

## WALL DIFFUSER

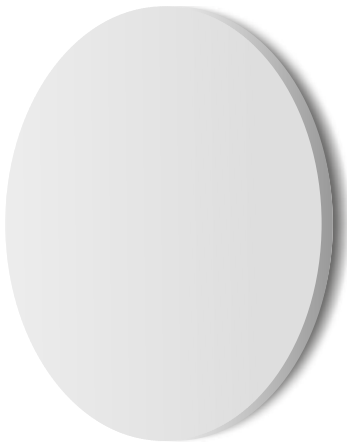

SIDE ROUND



SIDE SQUARE

160 mm

DIAMETER OF COUPLING SLEEVE

3.968 kg

WEIGHT WITHOUT PACKAGING (NET)

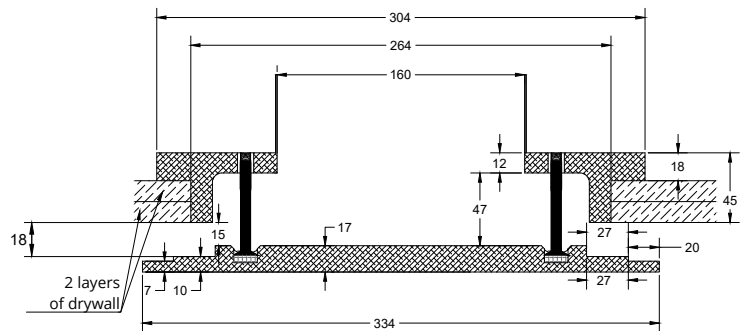
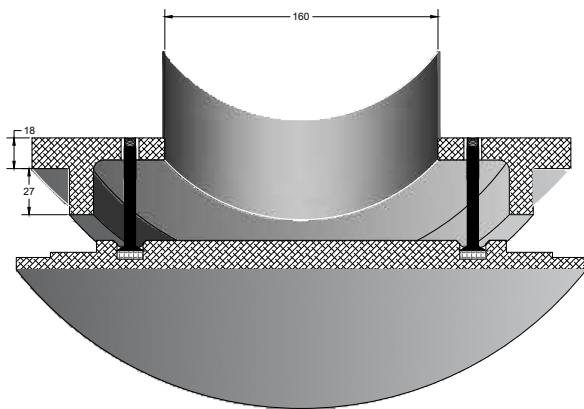

### Airborne noise and resistance, 1 m.

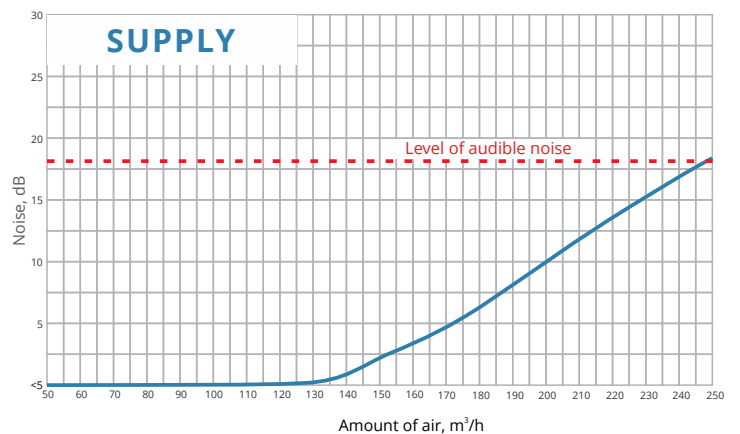
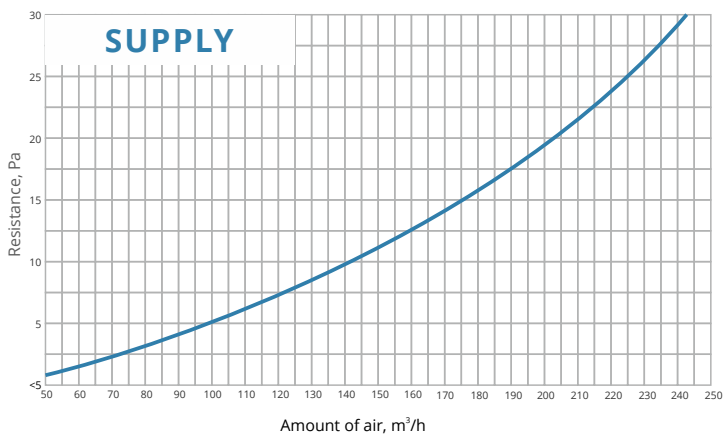

Due to its unique design, the SIDE diffuser distributes air horizontally when installed in the ceiling or vertically when installed on a wall, allowing it to provide comfortable airflow to occupants even when mounted above seating or desks.

## SENSIBLE AIRFLOW

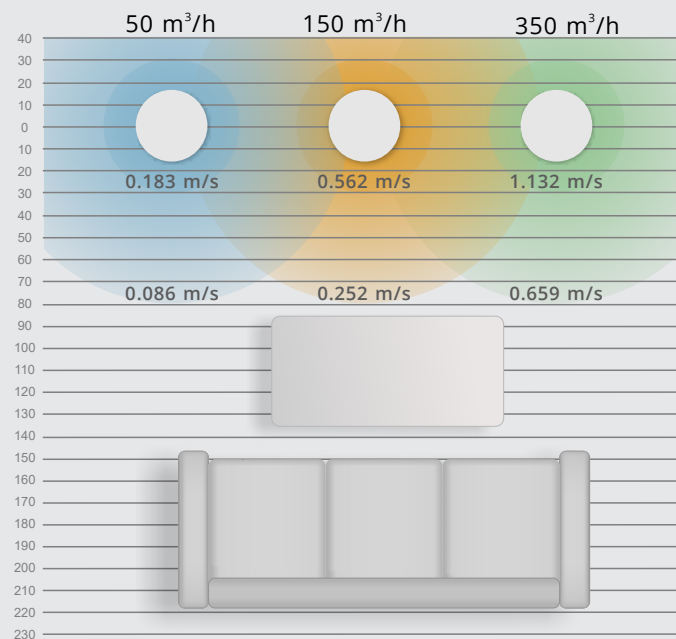

Airflow perceptible with Ventmann SIDE diffuser in the ceiling (top view)

## Air velocity at distance from diffuser

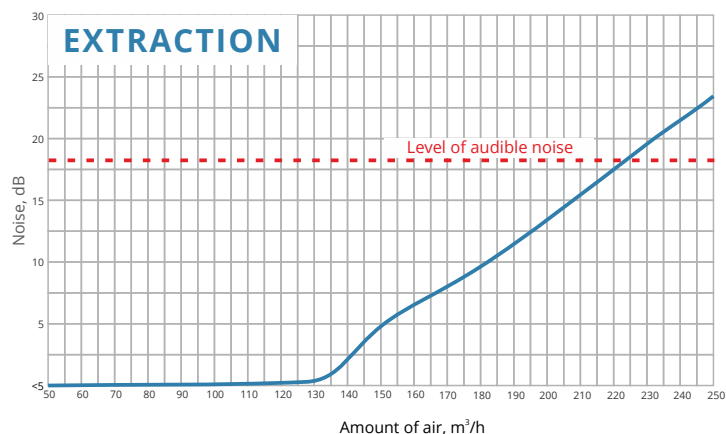
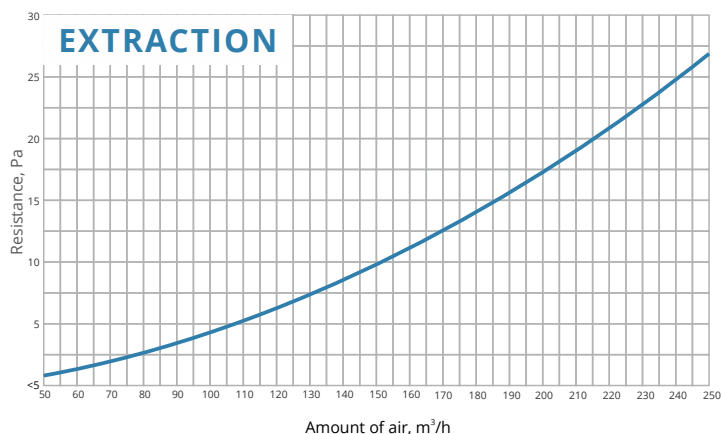
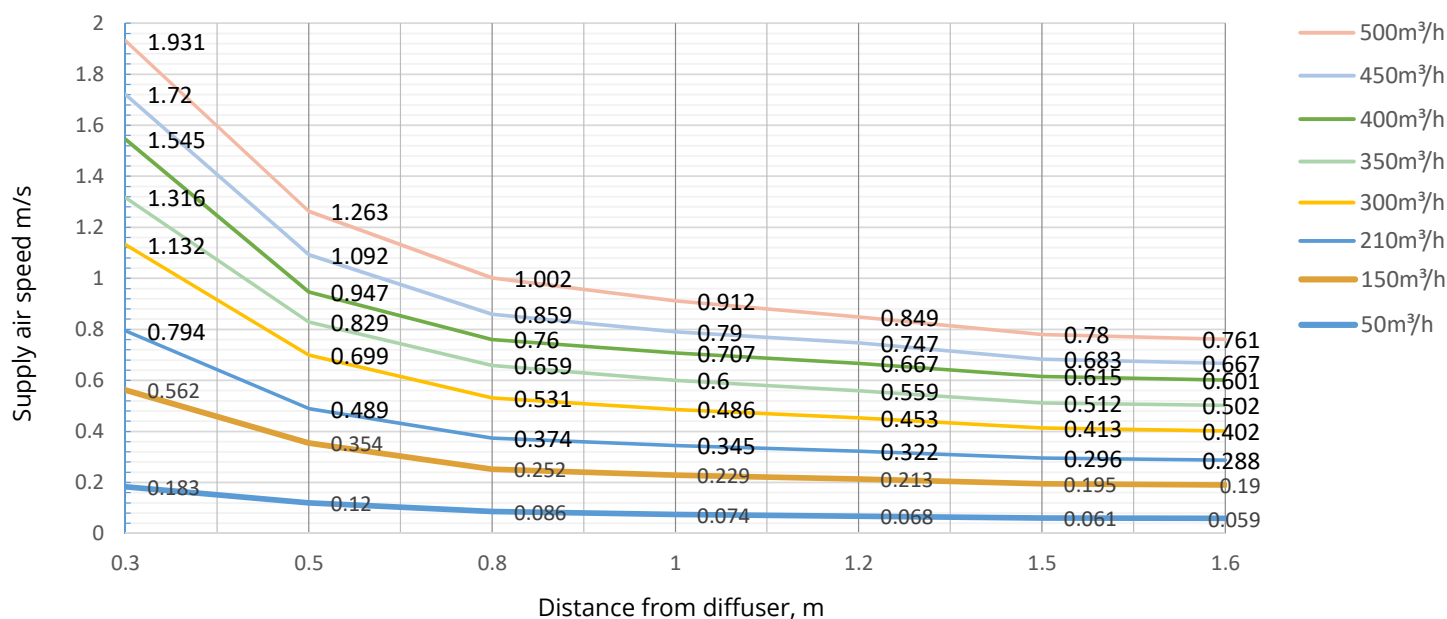

# SIDE 200/250

## WALL DIFFUSERS

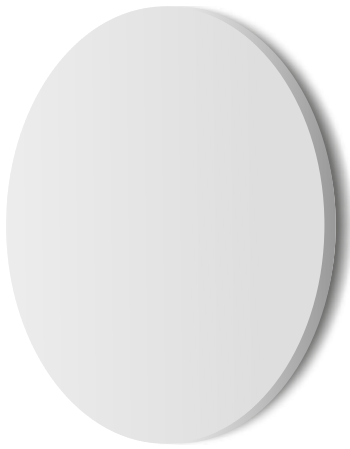

SIDE ROUND



SIDE SQUARE

200/250 mm

DIAMETER OF COUPLING SLEEVE

4.8 kg

ROUND MODEL WEIGHT WITHOUT  
PACKAGING (NET)

6.2 kg

SQUARE MODEL WEIGHT WITHOUT  
PACKAGING (NET)

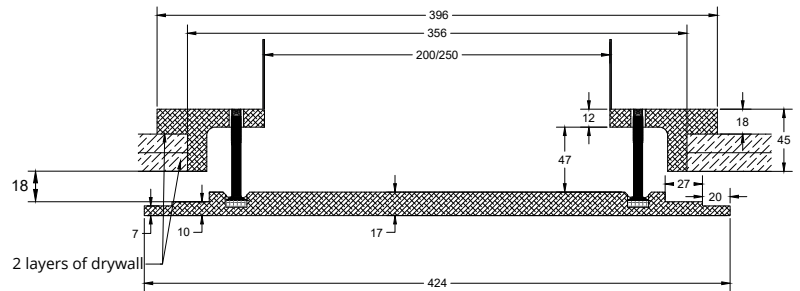
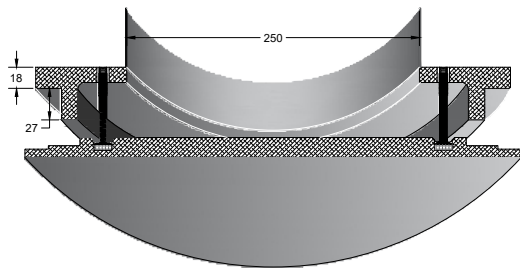

### Airborne noise and resistance, 1 m.

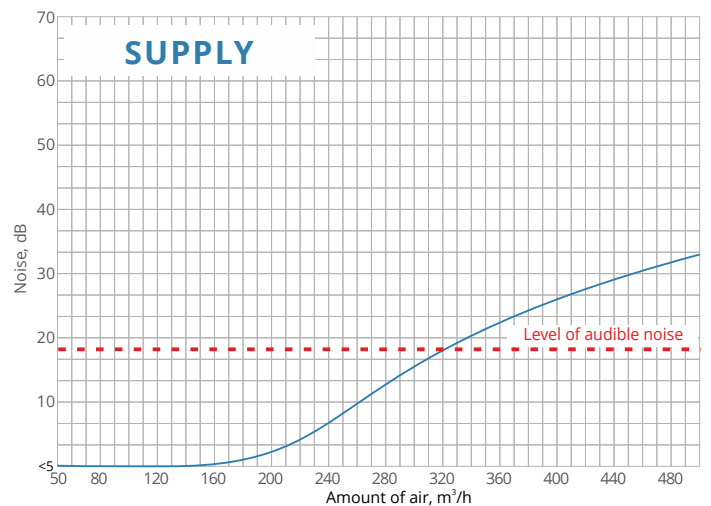
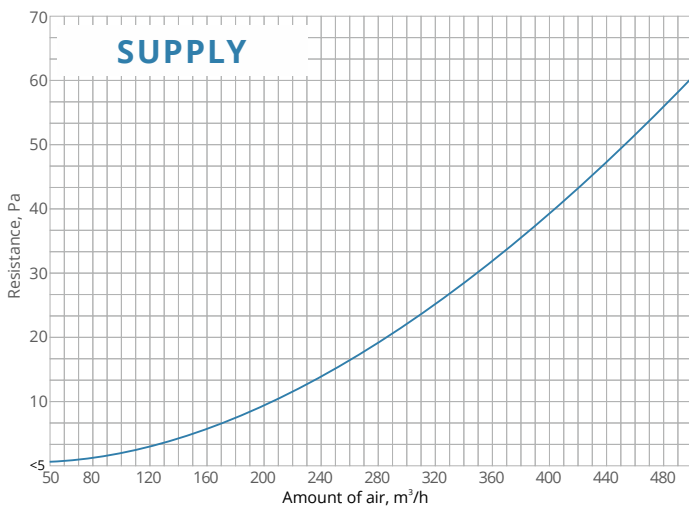

Due to its unique design, the SIDE diffuser distributes air horizontally when installed in the ceiling or vertically when installed on a wall, allowing it to provide comfortable airflow to occupants even when mounted above seating or desks.

## SENSIBLE AIRFLOW

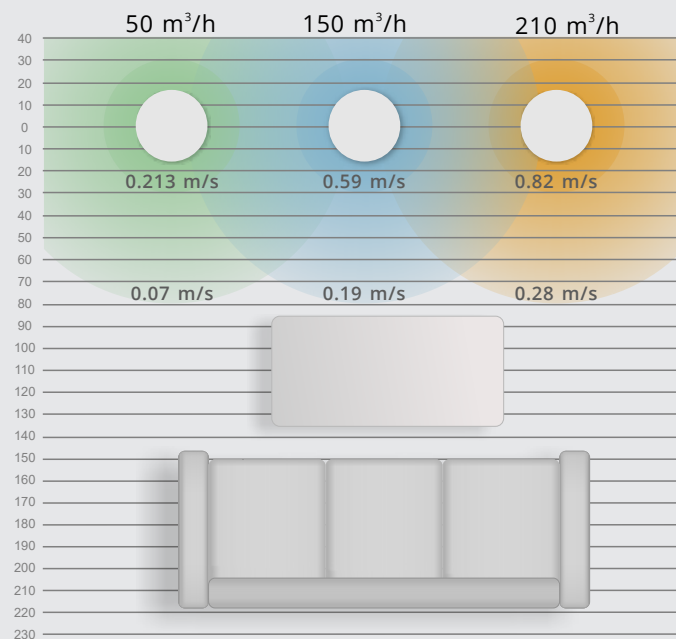

Airflow perceptible with Ventmann SIDE diffuser in the ceiling (top view)

## Air velocity at distance from diffuser

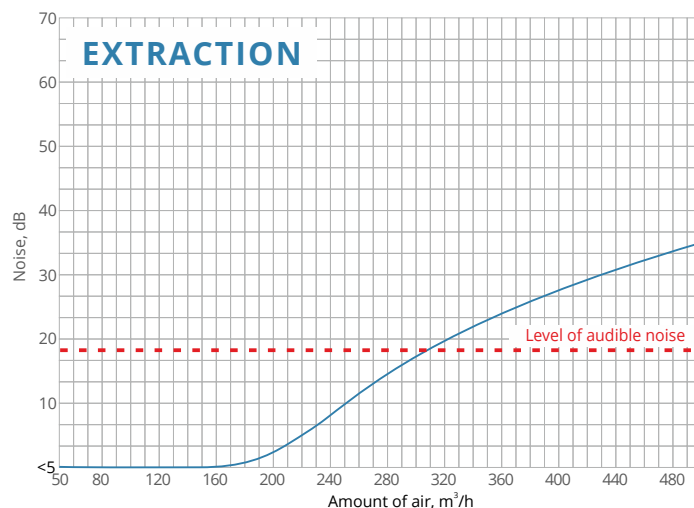
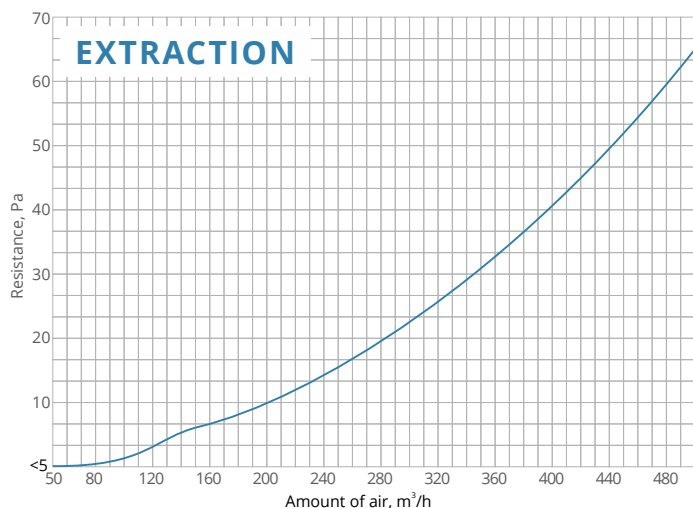
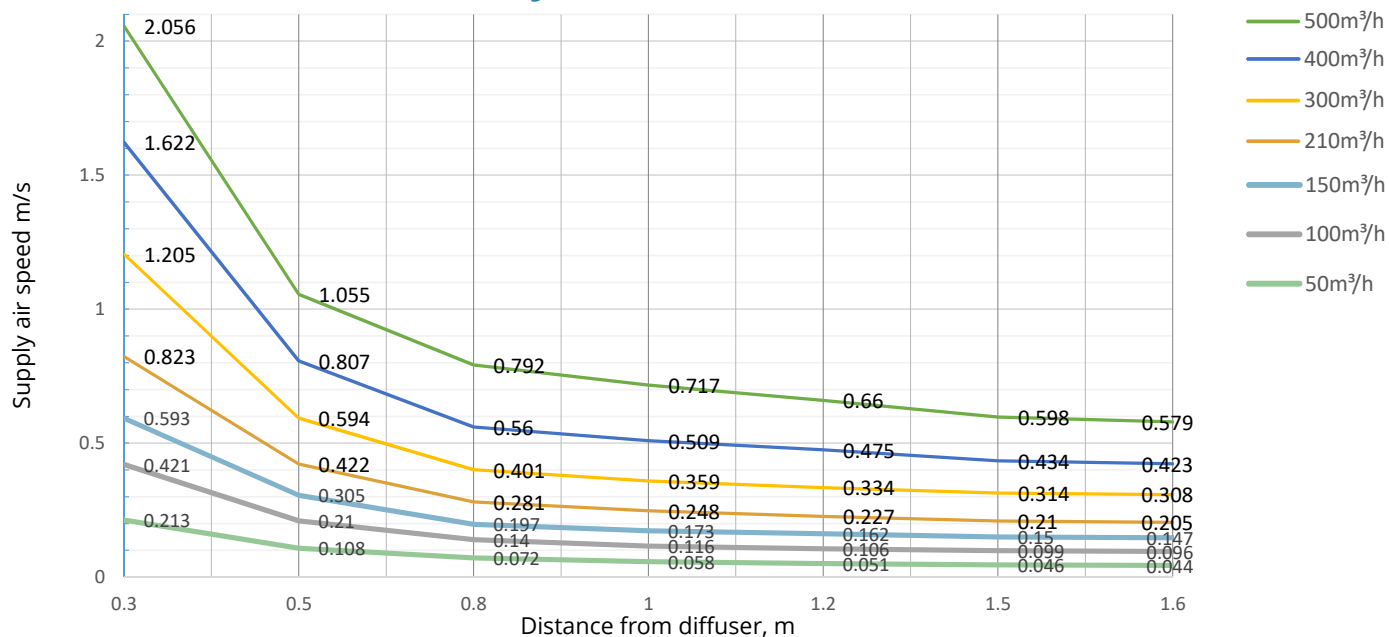

# CONTACT US

**EMAIL**

[sales@ventmann.co.uk](mailto:sales@ventmann.co.uk)

**TELEPHONE**

01283 240025

**ADDRESS**

Unit 6  
George Holmes Business Centre  
George Holmes Way  
Swadlincote  
Derbyshire  
DE11 9DF  
United Kingdom

**WEBSITE**

[www.ventmann.co.uk](http://www.ventmann.co.uk)

